

## 5

## Adjustment screws and threaded bushings

Tapped bushings for oval, triangular, square, rectangular, and round tubes. Height adjustment screws, adjuster plates, adjustment screws, machine and device bases and feet.

**HDE**

Page: 2

**HTE**

Page: 4

**HVB**

Page: 6

**HVB 2**

Page: 8

**HVD**

Page: 11

**HVF**

Page: 15

**HVF-HVD 2**

Page: 18

**HVR**

Page: 20

**HVT**

Page: 21

**K 1**

Page: 25

**K 2**

Page: 26

**K 3**

Page: 27

**KB**

Page: 28

**KF 1**

Page: 29

**KF 2**

Page: 30

**KK**

Page: 31

**KKO**

Page: 32

**KL**

Page: 33

**KR**

Page: 34

**KRI**

Page: 36

**KS**

Page: 37

**KT**

Page: 38

**KTGC**

Page: 40

**KW**

Page: 41

**L 1**

Page: 42

**L 2**

Page: 43

**LF**

Page: 44

**LS**

Page: 45

**LSF**

Page: 46

**YK**

Page: 47

**SDL**

Page: 48

**RQ**

Page: 50

**RR**

Page: 51

**JR**

Page: 52

**JRK**

Page: 53

**JRL**

Page: 54

**J 2**

Page: 56

**J 3**

Page: 57

**JEH**

Page: 58

**JEV**

Page: 59

**JM**

Page: 60

**JS**

Page: 61

**JV 1**

Page: 62

**JV 2**

Page: 63

**J 1**

Page: 64

**C**

Page: 65

**CE**

Page: 66

**CG 1**

Page: 67

**CG 2**

Page: 68

## Adjustment screws

Application: height adjustment screws  
Additional Info: with zinc-plated screws, mounted, with stainless steel cover  
Material: polypropylene / stainless steel cap  
Standard-Colour: metal

HDE

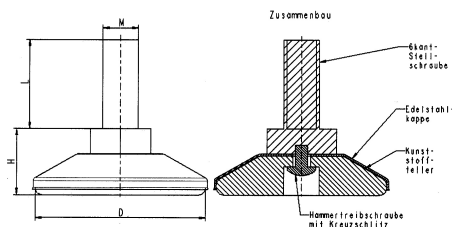

Order No.	Article	Hexagon screw	Plate Ø	Height	Colour	PU*	MOQ**
		M x L	D	H			
760130010001/ES	HDE 30, M 8x16	M 8x16	30	16,5	black	200	400
760130020001/ES	HDE 30, M 8x20	M 8x20	30	16,5	black	400	400
760130030001/ES	HDE 30, M 8x30	M 8x30	30	16,5	black	200	400
760130040001/ES	HDE 30, M 8x40	M 8x40	30	16,5	black	200	400
760130050001/ES	HDE 30, M 8x50	M 8x50	30	16,5	black	100	400
760130060001/ES	HDE 30, M 8x60	M 8x60	30	16,5	black	100	400
760130070001/ES	HDE 30, M 8x70	M 8x70	30	16,5	black	100	400
760130210001/ES	HDE 30, M 10x16	M 10x16	30	17,5	black	200	400
760130220001/ES	HDE 30, M 10x20	M 10x20	30	17,5	black	200	400
760130230001/ES	HDE 30, M 10x30	M 10x30	30	17,5	black	200	400
760130240001/ES	HDE 30, M 10x40	M 10x40	30	17,5	black	100	400
760130250001/ES	HDE 30, M 10x50	M 10x50	30	17,5	black	100	400
760130260001/ES	HDE 30, M 10x60	M 10x60	30	17,5	black	200	400
760130270001/ES	HDE 30, M 10x70	M 10x70	30	17,5	black	100	400
760138010001/ES	HDE 38, M 8x16	M 8x16	38	17,0	black	200	400
760138020001/ES	HDE 38, M 8x20	M 8x20	38	17,0	black	100	400
760138030001/ES	HDE 38, M 8x30	M 8x30	38	17,0	black	100	400
760138040001/ES	HDE 38, M 8x40	M 8x40	38	17,0	black	100	400
760138050001/ES	HED 38, M 8x50	M 8x50	38	17,0	black	100	400
760138060001/ES	HDE 38, M 8x60	M 8x60	38	17,0	black	300	600
760138070001/ES	HDE 38, M 8x70	M 8x70	38	17,0	black	100	400
760138210001/ES	HDE 38, M 10x16	M 10x16	38	18,0	black	100	400
760138220001/ES	HDE 38, M 10x20	M 10x20	38	18,0	black	100	400
760138230001/ES	HDE 38, M 10x30	M 10x30	38	18,0	black	100	400
760138240001/ES	HDE 38, M 10x40	M 10x40	38	18,0	black	100	400
760138250001/ES	HDE 38, M 10x50	M 10x50	38	18,0	black	100	400
760138260001/ES	HDE 38, M 10x60	M 10x60	38	18,0	black	100	400
760138270001/ES	HDE 38, M 10x70	M 10x70	38	18,0	black	50	400
760148010001/ES	HDE 48, M 8x16	M 8x16	48	17,0	black	100	400
760148020001/ES	HDE 48, M 8x20	M 8x20	48	17,0	black	250	500
760148030001/ES	HDE 48, M 8x30	M 8x30	48	17,0	black	100	400

Please note that the product illustrations are exemplary images that could deviate from the ordered/delivered products.

All of the dimensions are in mm should nothing to the contrary be stated.

\*PU = Packaging Unit, SW = Spanner opening, n.w. = not detachable, o. K. = excl. The head, o. B. = excl. The collar, m. R. = with the radius, MOQ = Minimum Order Quantity.

\*\* MOQ: Parts with MOQ, set-up costs may apply.

We exclusively sell to the trade and industry. Please note our minimum order quantities and the minimum order value per delivery.  
We would be pleased to send you an offer that is tailored to your needs should you require special colours, deviating dimensions, bioplastics, or larger order quantities.

## Adjustment screws

Application: height adjustment screws  
Material: polypropylene / stainless steel cap  
Standard-Colour: metal

HDE

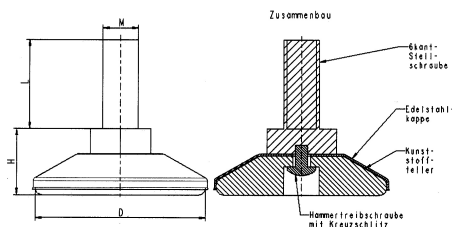

Order No.	Article	Hexagon screw	Plate Ø	Height	Colour	PU*	MOQ**
		M x L	D	H			
760148040001/ES	HDE 48, M 8x40	M 8x40	48	17,0	black	50	400
760148050001/ES	HDE 48, M 8x50	M 8x50	48	17,0	black	50	400
760148060001/ES	HDE 48, M 8x60	M 8x60	48	17,0	black	100	400
760148070001/ES	HDE 48, M 8x70	M 8x70	48	17,0	black	200	400
760148210001/ES	HDE 48, M 10x16	M 10x16	48	19,0	black	100	400
760148220001/ES	HDE 48, M 10x20	M 10x20	48	18,0	black	100	400
760148230001/ES	HDE 48, M 10x30	M 10x30	48	18,0	black	200	400
760148240001/ES	HDE 48, M 10x40	M 10x40	48	18,0	black	50	400
760148250001/ES	HDE 48, M 10x50	M 10x50	48	18,0	black	50	400
760148260001/ES	HDE 48, M 10x60	M 10x60	48	18,0	black	100	400
760148270001/ES	HDE 48, M 10x70	M 10x70	48	18,0	black	200	-

Please note that the product illustrations are exemplary images that could deviate from the ordered/delivered products.

All of the dimensions are in mm should nothing to the contrary be stated.

\*PU = Packaging Unit, SW = Spanner opening, n.w. = not detachable, o. K. = excl. The head, o. B. = excl. The collar, m. R. = with the radius, MOQ = Minimum Order Quantity.

\*\* MOQ: Parts with MOQ, set-up costs may apply.

We exclusively sell to the trade and industry. Please note our minimum order quantities and the minimum order value per delivery.  
We would be pleased to send you an offer that is tailored to your needs should you require special colours, deviating dimensions, bioplastics, or larger order quantities.

## Adjustment screws

Application: height adjustment screws  
Additional Info: with zinc-plated screws, mounted, with stainless steel cover  
Material: polypropylene / stainless steel cap  
Standard-Colour: metal

HTE

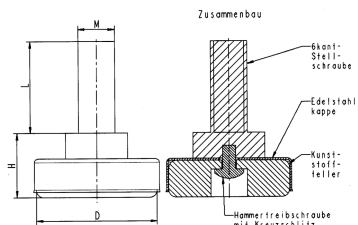

Order No.	Article	Hexagon screw	Plate Ø	Height	Colour	PU*	MOQ**
		M x L	D	H			
760123010001/ES	HTE 23, M 8x16	M 8x16	23	16	black	200	1000
760123020001/ES	HTE 23, M 8x20	M 8x20	23	16	black	200	-
760123030001/ES	HTE 23, M 8x30	M 8x30	23	16	black	200	1000
760123040001/ES	HTE 23, M 8x40	M 8x40	23	16	black	200	1000
760123050001/ES	HTE 23, M 8x50	M 8x50	23	16	black	200	1000
760123060001/ES	HTE 23, M 8x60	M 8x60	23	16	black	200	1000
760123070001/ES	HTE 23, M 8x70	M 8x70	23	16	black	200	1000
760123210001/ES	HTE 23, M 10x16	M 10x16	23	17	black	200	1000
760123220001/ES	HTE 23, M 10x20	M 10x20	23	17	black	200	1000
760123230001/ES	HTE 23, M 10x30	M 10x30	23	17	black	200	1000
760123240001/ES	HTE 23, M 10x40	M 10x40	23	17	black	100	1000
760123250001/ES	HTE 23, M 10x50	M 10x50	23	17	black	100	1000
760123260001/ES	HTE 23, M 10x60	M 10x60	23	17	black	100	1000
760123270001/ES	HTE 23, M 10x70	M 10x70	23	17	black	100	1000
760128010001/ES	HTE 28, M 8x16	M 8x16	28	16	black	200	1000
760128020001/ES	HTE 28, M 8x20	M 8x20	28	16	black	200	1000
760128030001/ES	HTE 28, M 8x30	M 8x30	28	16	black	200	1000
760128040001/ES	HTE 28, M 8x40	M 8x40	28	16	black	200	1000
760128050001/ES	HTE 28, M 8x50	M 8x50	28	16	black	200	1000
760128060001/ES	HTE 28, M 8x60	M 8x60	28	16	black	100	900
760128070001/ES	HTE 28, M 8x70	M 8x70	28	16	black	100	900
760128210001/ES	HTE 28, M 10x16	M 10x16	28	17	black	200	1000
760128220001/ES	HTE 28, M 10x20	M 10x20	28	17	black	200	1000
760128230001/ES	HTE 28, M 10x30	M 10x30	28	17	black	200	1000
760128240001/ES	HTE 28, M 10x40	M 10x40	28	17	black	100	900
760128250001/ES	HTE 28, M 10x50	M 10x50	28	17	black	100	900
760128260001/ES	HTE 28, M 10x60	M 10x60	28	17	black	100	900
760128270001/ES	HTE 28, M 10x70	M 10x70	28	17	black	100	900
760133010001/ES	HTE 33, M 8x16	M 8x16	33	16	black	200	1000
760133020001/ES	HTE 33, M 8x20	M 8x20	33	16	black	200	1000
760133030001/ES	HTE 33, M 8x30	M 8x30	33	16	black	100	900

Please note that the product illustrations are exemplary images that could deviate from the ordered/delivered products.

All of the dimensions are in mm should nothing to the contrary be stated.

\*PU = Packaging Unit, SW = Spanner opening, n.w. = not detachable, o. K. = excl. The head, o. B. = excl. The collar, m. R. = with the radius, MOQ = Minimum Order Quantity.

\*\* MOQ: Parts with MOQ, set-up costs may apply.

We exclusively sell to the trade and industry. Please note our minimum order quantities and the minimum order value per delivery.  
We would be pleased to send you an offer that is tailored to your needs should you require special colours, deviating dimensions, bioplastics, or larger order quantities.

## Adjustment screws

Application: height adjustment screws  
Material: polypropylene / stainless steel cap  
Standard-Colour: metal

HTE

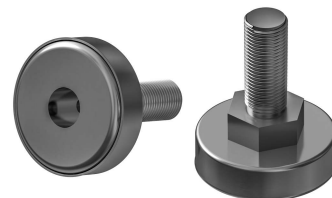
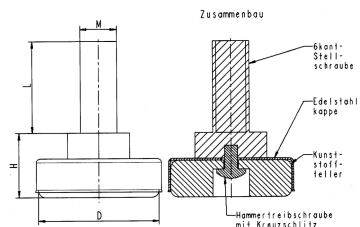

Order No.	Article	Hexagon screw	Plate Ø	Height	Colour	PU*	MOQ**
		M x L	D	H			
760133040001/ES	HTE 33, M 8x40	M 8x40	33	16	black	100	900
760133050001/ES	HTE 33, M 8x50	M 8x50	33	16	black	100	900
760133060001/ES	HTE 33, M 8x60	M 8x60	33	16	black	100	900
760133210001/ES	HTE 33, M 10x16	M 10x16	33	17	black	200	1000
760133220001/ES	HTE 33, M 10x20	M 10x20	33	17	black	100	900
760133230001/ES	HTE 33, M 10x30	M 10x30	33	17	black	250	-
760133240001/ES	HTE 33, M 10x40	M 10x40	33	17	black	100	900
760133250001/ES	HTE 33, M 10x50	M 10x50	33	17	black	100	900
760133260001/ES	HTE 33, M 10x60	M 10x60	33	17	black	100	900
760133270001/ES	HTE 33, M 10x70	M 10x70	33	17	black	100	900

Please note that the product illustrations are exemplary images that could deviate from the ordered/delivered products.

All of the dimensions are in mm should nothing to the contrary be stated.

\*PU = Packaging Unit, SW = Spanner opening, n.w. = not detachable, o. K. = excl. The head, o. B. = excl. The collar, m. R. = with the radius, MOQ = Minimum Order Quantity.

\*\* MOQ: Parts with MOQ, set-up costs may apply.

We exclusively sell to the trade and industry. Please note our minimum order quantities and the minimum order value per delivery.  
We would be pleased to send you an offer that is tailored to your needs should you require special colours, deviating dimensions, bioplastics, or larger order quantities.

## Adjustment screws

Application: height adjustment screws  
 Additional Info: mounted on swivelling, zinc-plated plate  
 with drill holes  
 Material: sheet steel, steel screws, zinc-plated  
 Standard-Colour: metal

HVB

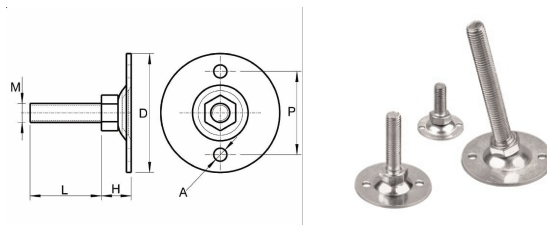

Order No.	Plate Ø D	Hexagon screw	Height	Mounting hole	Hole spacing	SW	Colour	PU*	MOQ**
		M x L	H	A	P				
760530010004000	30	M 8x16	11,0	4,0	24,3	13	zincplated	200	400
760530020004000	30	M 8x20	11,0	4,0	24,3	13	zincplated	200	400
760530030004000	30	M 8x30	11,0	4,0	24,3	13	zincplated	500	500
760530040004000	30	M 8x40	11,0	4,0	24,3	13	zincplated	200	-
760530050004000	30	M 8x50	11,0	4,0	24,3	13	zincplated	200	400
760530060004000	30	M 8x60	11,0	4,0	24,3	13	zincplated	200	400
760530070004000	30	M 8x70	11,0	4,0	24,3	13	zincplated	100	400
760530210004000	30	M 10x16	12,5	4,0	24,3	17	zincplated	200	400
760530220004000	30	M 10x20	12,5	4,0	24,3	17	zincplated	200	400
760530230004000	30	M 10x30	12,5	4,0	24,3	17	zincplated	200	-
760530240004000	30	M 10x40	12,5	4,0	24,3	17	zincplated	300	-
760530250004000	30	M 10x50	12,5	4,0	24,3	17	zincplated	300	600
760530260004000	30	M 10x60	12,5	4,0	24,3	17	zincplated	100	-
760530270004000	30	M 10x70	12,5	4,0	24,3	17	zincplated	100	400
760540010004000	40	M 8x16	11,0	5,0	30,0	13	zincplated	200	400
760540020004000	40	M 8x20	11,0	5,0	30,0	13	zincplated	200	400
760540030004000	40	M 8x30	11,0	5,0	30,0	13	zincplated	100	400
760540040004000	40	M 8x40	11,0	5,0	30,0	13	zincplated	100	400
760540050004000	40	M 8x50	11,0	5,0	30,0	13	zincplated	100	400
760540060004000	40	M 8x60	11,0	5,0	30,0	13	zincplated	100	400
760540070004000	40	M 8x70	11,0	5,0	30,0	13	zincplated	100	400
760540210004000	40	M 10x16	11,0	5,0	30,0	17	zincplated	200	400
760540220004000	40	M 10x20	11,0	5,0	30,0	17	zincplated	200	400
760540230004000	40	M 10x30	11,0	5,0	30,0	17	zincplated	100	400
760540240004000	40	M 10x40	11,0	5,0	30,0	17	zincplated	300	600
760540250004000	40	M 10x50	11,0	5,0	30,0	17	zincplated	100	400
760540260004000	40	M 10x60	11,0	5,0	30,0	17	zincplated	100	400
760540270004000	40	M 10x70	11,0	5,0	30,0	17	zincplated	100	-
760550010004000	50	M 8x16	12,5	5,5	35,0	13	zincplated	100	400
760550020004000	50	M 8x20	12,5	5,5	35,0	13	zincplated	100	400
760550030004000	50	M 8x30	12,5	5,5	35,0	13	zincplated	100	400

Please note that the product illustrations are exemplary images that could deviate from the ordered/delivered products.

All of the dimensions are in mm should nothing to the contrary be stated.

\*PU = Packaging Unit, SW = Spanner opening, n.w. = not detachable, o. K. = excl. The head, o. B. = excl. The collar, m. R. = with the radius, MOQ = Minimum Order Quantity.

\*\* MOQ: Parts with MOQ, set-up costs may apply.

! We exclusively sell to the trade and industry. Please note our minimum order quantities and the minimum order value per delivery.  
 We would be pleased to send you an offer that is tailored to your needs should you require special colours, deviating dimensions, bioplastics, or larger order quantities.

## Adjustment screws

Application: height adjustment screws  
Material: sheet steel, steel screws, zinc-plated  
Standard-Colour: metal

HVB

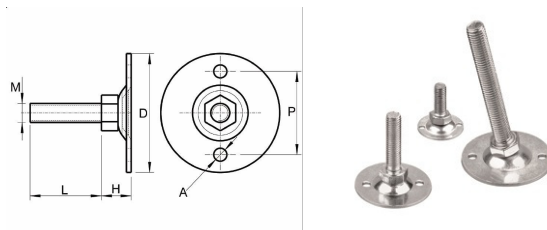

Order No.	Plate Ø D	Hexagon screw	Height	Mounting hole	Hole spacing	SW	Colour	PU*	MOQ**
		M x L	H	A	P				
760550040004000	50	M 8x40	12,5	5,5	35,0	13	zincplated	100	400
760550050004000	50	M 8x50	12,5	5,5	35,0	13	zincplated	100	400
760550060004000	50	M 8x60	12,5	5,5	35,0	13	zincplated	100	400
760550070004000	50	M 8x70	12,5	5,5	35,0	13	zincplated	100	400
760550210004000	50	M 10x16	14,0	5,5	35,0	17	zincplated	100	400
760550220004000	50	M 10x20	14,0	5,5	35,0	17	zincplated	100	400
760550230004000	50	M 10x30	14,0	5,5	35,0	17	zincplated	100	400
760550240004000	50	M 10x40	14,0	5,5	35,0	17	zincplated	100	400
760550250004000	50	M 10x50	14,0	5,5	35,0	17	zincplated	50	400
760550260004000	50	M 10x60	14,0	5,5	35,0	17	zincplated	200	-
760550270004000	50	M 10x70	14,0	5,5	35,0	17	zincplated	50	-
760560010004000	60	M 8x16	13,5	5,5	46,0	13	zincplated	100	400
760560020004000	60	M 8x20	13,5	5,5	46,0	13	zincplated	100	400
760560030004000	60	M 8x30	13,5	5,5	46,0	13	zincplated	100	400
760560040004000	60	M 8x40	13,5	5,5	46,0	13	zincplated	100	400
760560050004000	60	M 8x50	13,5	5,5	46,0	13	zincplated	100	400
760560060004000	60	M 8x60	13,5	5,5	46,0	13	zincplated	100	400
760560070004000	60	M 8x70	13,5	5,5	46,0	13	zincplated	100	400
760560210004000	60	M 10x16	15,0	5,5	46,0	17	zincplated	100	400
760560220004000	60	M 10x20	15,0	5,5	46,0	17	zincplated	100	400
760560230004000	60	M 10x30	15,0	5,5	46,0	17	zincplated	50	400
760560240004000	60	M 10x40	15,0	5,5	46,0	17	zincplated	100	-
760560250004000	60	M 10x50	15,0	5,5	46,0	17	zincplated	100	-
760560260004000	60	M 10x60	15,0	5,5	46,0	17	zincplated	100	-
760560270004000	60	M 10x70	15,0	5,5	46,0	17	zincplated	100	-

Please note that the product illustrations are exemplary images that could deviate from the ordered/delivered products.

All of the dimensions are in mm should nothing to the contrary be stated.

\*PU = Packaging Unit, SW = Spanner opening, n.w. = not detachable, o. K. = excl. The head, o. B. = excl. The collar, m. R. = with the radius, MOQ = Minimum Order Quantity.

\*\* MOQ: Parts with MOQ, set-up costs may apply.

We exclusively sell to the trade and industry. Please note our minimum order quantities and the minimum order value per delivery.  
We would be pleased to send you an offer that is tailored to your needs should you require special colours, deviating dimensions, bioplastics, or larger order quantities.

## Adjustment screws

Application: height adjustment screws  
Additional Info: mounted on swivelling, zinc-plated plate  
without drill holes  
Material: sheet steel, steel screws, zinc-plated  
Standard-Colour: metal

## HVB 2

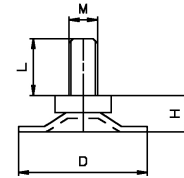

Order No.	Plate Ø	Hexagon screw	Height	SW	Colour	PU*	MOQ**
	D	M x L	H				
760330010004000	30	M 8x16	11,0	13	zincplated	200	400
760330020004000	30	M 8x20	11,0	13	zincplated	200	-
760330030004000	30	M 8x30	11,0	13	zincplated	400	-
760330040004000	30	M 8x40	11,0	13	zincplated	400	-
760330050004000	30	M 8x50	11,0	13	zincplated	100	-
760330060004000	30	M 8x60	11,0	13	zincplated	100	400
760330070004000	30	M 8x70	11,0	13	zincplated	100	400
760330210004000	30	M 10x16	12,5	17	zincplated	200	400
760330220004000	30	M 10x20	12,5	17	zincplated	200	400
760330230004000	30	M 10x30	12,5	17	zincplated	400	-
760330240004000	30	M 10x40	12,5	17	zincplated	100	400
760330250004000	30	M 10x50	12,5	17	zincplated	300	600
760330260004000	30	M 10x60	12,5	17	zincplated	100	-
760330270004000	30	M 10x70	12,5	17	zincplated	100	400
760340010004000	40	M 8x16	12,5	13	zincplated	200	400
760340020004000	40	M 8x20	12,5	13	zincplated	200	400
760340030004000	40	M 8x30	12,5	13	zincplated	100	400
760340040004000	40	M 8x40	12,5	13	zincplated	100	400
760340050004000	40	M 8x50	12,5	13	zincplated	100	400
760340060004000	40	M 8x60	12,5	13	zincplated	100	400
760340070004000	40	M 8x70	12,5	13	zincplated	100	400
760340210004000	40	M 10x16	13,5	17	zincplated	200	400
760340220004000	40	M 10x20	13,5	17	zincplated	200	400
760340230004000	40	M 10x30	13,5	17	zincplated	100	-
760340240004000	40	M 10x40	13,5	17	zincplated	100	-
760340250004000	40	M 10x50	13,5	17	zincplated	100	400
760340260004000	40	M 10x60	13,5	17	zincplated	50	-
760340270004000	40	M 10x70	13,5	17	zincplated	100	400
760345010004000	45	M 8x16	12,5	13	zincplated	200	400
760345020004000	45	M 8x20	12,5	13	zincplated	100	400
760345030004000	45	M 8x30	12,5	13	zincplated	300	600

Please note that the product illustrations are exemplary images that could deviate from the ordered/delivered products.

All of the dimensions are in mm should nothing to the contrary be stated.

\*PU = Packaging Unit, SW = Spanner opening, n.w. = not detachable, o. K. = excl. The head, o. B. = excl. The collar, m. R. = with the radius, MOQ = Minimum Order Quantity.

\*\* MOQ: Parts with MOQ, set-up costs may apply.

We exclusively sell to the trade and industry. Please note our minimum order quantities and the minimum order value per delivery.  
We would be pleased to send you an offer that is tailored to your needs should you require special colours, deviating dimensions, bioplastics, or larger order quantities.



## Adjustment screws

Application: height adjustment screws  
Material: sheet steel, steel screws, zinc-plated  
Standard-Colour: metal

## HVB 2

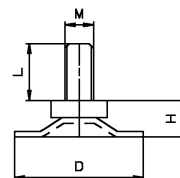

Order No.	Plate Ø	Hexagon screw	Height	SW	Colour	PU*	MOQ**
	D	M x L	H				
760345040004000	45	M 8x40	12,5	13	zincplated	300	600
760345050004000	45	M 8x50	12,5	13	zincplated	100	400
760345060004000	45	M 8x60	12,5	13	zincplated	100	400
760345070004000	45	M 8x70	12,5	13	zincplated	100	400
760345220004000	45	M 10x20	13,5	17	zincplated	100	400
760345230004000	45	M 10x30	13,5	17	zincplated	100	-
760345240004000	45	M 10x40	13,5	17	zincplated	250	500
760345250004000	45	M 10x50	13,5	17	zincplated	200	-
760345260004000	45	M 10x60	13,5	17	zincplated	200	-
760345270004000	45	M 10x70	13,5	17	zincplated	200	400
760350010004000	50	M 8x16	12,5	13	zincplated	100	400
760350020004000	50	M 8x20	12,5	13	zincplated	100	400
760350030004000	50	M 8x30	12,5	13	zincplated	100	400
760350040004000	50	M 8x40	12,5	13	zincplated	100	400
760350050004000	50	M 8x50	12,5	13	zincplated	100	400
760350060004000	50	M 8x60	12,5	13	zincplated	250	500
760350070004000	50	M 8x70	12,5	13	zincplated	100	400
760350210004000	50	M 10x16	14,0	17	zincplated	100	400
760350220004000	50	M 10x20	14,0	17	zincplated	100	400
760350230004000	50	M 10x30	14,0	17	zincplated	100	400
760350240004000	50	M 10x40	14,0	17	zincplated	200	-
760350250004000	50	M 10x50	14,0	17	zincplated	50	400
760350260004000	50	M 10x60	14,0	17	zincplated	200	-
760350270004000	50	M 10x70	14,0	17	zincplated	50	400
760360010004000	60	M 8x16	13,5	13	zincplated	100	400
760360020004000	60	M 8x20	13,5	13	zincplated	100	400
760360030004000	60	M 8x30	13,5	13	zincplated	50	400
760360040004000	60	M 8x40	13,5	13	zincplated	100	400
760360050004000	60	M 8x50	13,5	13	zincplated	100	400
760360060004000	60	M 8x60	13,5	13	zincplated	100	400
760360070004000	60	M 8x70	13,5	13	zincplated	100	400

Please note that the product illustrations are exemplary images that could deviate from the ordered/delivered products.

All of the dimensions are in mm should nothing to the contrary be stated.

\*PU = Packaging Unit, SW = Spanner opening, n.w. = not detachable, o. K. = excl. The head, o. B. = excl. The collar, m. R. = with the radius, MOQ = Minimum Order Quantity.

\*\* MOQ: Parts with MOQ, set-up costs may apply.

! We exclusively sell to the trade and industry. Please note our minimum order quantities and the minimum order value per delivery.  
We would be pleased to send you an offer that is tailored to your needs should you require special colours, deviating dimensions, bioplastics, or larger order quantities.

## Adjustment screws

Application: height adjustment screws  
Material: sheet steel, steel screws, zinc-plated  
Standard-Colour: metal

## HVB 2

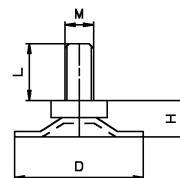

Order No.	Plate Ø	Hexagon screw	Height	SW	Colour	PU*	MOQ**
	D	M x L	H				
760360210004000	60	M 10x16	15,0	17	zincplated	100	400
760360220004000	60	M 10x20	15,0	17	nature	50	400
760360230004000	60	M 10x30	15,0	17	zincplated	100	400
760360240004000	60	M 10x40	15,0	17	zincplated	100	-
760360250004000	60	M 10x50	15,0	17	zincplated	100	-
760360260004000	60	M 10x60	15,0	17	zincplated	100	400
760360270004000	60	M 10x70	15,0	17	zincplated	100	400

Please note that the product illustrations are exemplary images that could deviate from the ordered/delivered products.

All of the dimensions are in mm should nothing to the contrary be stated.

\*PU = Packaging Unit, SW = Spanner opening, n.w. = not detachable, o. K. = excl. The head, o. B. = excl. The collar, m. R. = with the radius, MOQ = Minimum Order Quantity.

\*\* MOQ: Parts with MOQ, set-up costs may apply.

We exclusively sell to the trade and industry. Please note our minimum order quantities and the minimum order value per delivery.  
We would be pleased to send you an offer that is tailored to your needs should you require special colours, deviating dimensions, bioplastics, or larger order quantities.

## Adjustment screws

Application: height adjustment screws  
Material: polypropylene / steel  
Standard-Colour: black

HVD

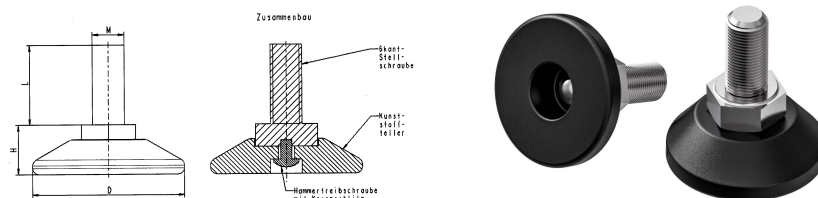

HVD Order No.	Hexagon screw	Plate Ø	Height HVD	Colour	PU*	MOQ**
	M x L	D	H			
760130010001000	8x16	30	16,0	black	200	-
760130020001000	8x20	30	16,0	black	500	-
760130030001000	8x30	30	16,0	black	500	-
760130040001000	8x40	30	16,0	black	400	-
760130050001000	8x50	30	16,0	black	400	-
760130060001000	8x60	30	16,0	black	300	-
760130070001000	8x70	30	16,0	black	400	-
760130080001000	8x80	30	16,0	black	100	-
760130090001000	8x90	30	16,0	black	100	-
760130100001000	8x100	30	16,0	black	300	600
760130110001000	8x120	30	16,0	black	100	400
760130210001000	10x16	30	17,0	black	200	400
760130220001000	10x20	30	17,0	black	200	400
760130230001000	10x30	30	17,0	black	400	-
760130240001000	10x40	30	17,0	black	300	-
760130250001000	10x50	30	17,0	black	300	-
760130260001000	10x60	30	17,0	black	300	-
760130270001000	10x70	30	17,0	black	250	500
760130280001000	10x80	30	17,0	black	200	-
760130290001000	10x90	30	17,0	black	200	400
760130300001000	10x100	30	17,0	black	200	-
760130310001000	10x120	30	17,0	black	200	-
760130410001000	12x30	30	18,5	black	250	500
760130420001000	12x40	30	18,5	black	100	400
760130430001000	12x50	30	18,5	black	100	400
760130440001000	12x60	30	18,5	black	100	400
760130450001000	12x70	30	18,5	black	100	400
760130460001000	12x80	30	18,5	black	100	400
760130470001000	12x90	30	18,5	black	100	400
760130480001000	12x100	30	18,5	black	100	400
760138010001000	8x16	38	16,5	black	200	400

Please note that the product illustrations are exemplary images that could deviate from the ordered/delivered products.

All of the dimensions are in mm should nothing to the contrary be stated.

\*PU = Packaging Unit, SW = Spanner opening, n.w. = not detachable, o. K. = excl. The head, o. B. = excl. The collar, m. R. = with the radius, MOQ = Minimum Order Quantity.

\*\* MOQ: Parts with MOQ, set-up costs may apply.

We exclusively sell to the trade and industry. Please note our minimum order quantities and the minimum order value per delivery.  
We would be pleased to send you an offer that is tailored to your needs should you require special colours, deviating dimensions, bioplastics, or larger order quantities.

## Adjustment screws

Application: height adjustment screws  
Material: polypropylene / steel  
Standard-Colour: black

HVD

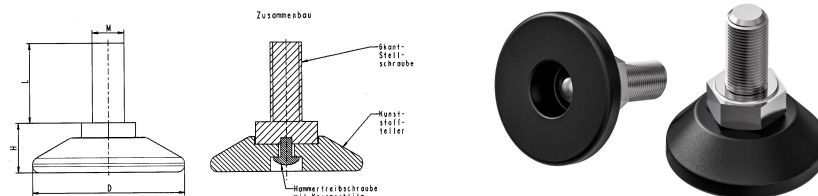

HVD Order No.	Hexagon screw	Plate Ø	Height HVD	Colour	PU*	MOQ**
	M x L	D	H			
760138020001000	8x20	38	16,5	black	100	400
760138030001000	8x30	38	16,5	black	300	-
760138040001000	8x40	38	16,5	black	100	-
760138050001000	8x50	38	16,5	black	300	-
760138060001000	8x60	38	16,5	black	300	-
760138070001000	8x70	38	16,5	black	100	400
760138080001000	8x80	38	16,5	black	200	-
760138090001000	8x90	38	16,5	black	100	400
760138100001000	8x100	38	16,5	black	100	400
760138110001000	8x120	38	16,5	black	100	400
760138210001000	10x16	38	17,5	black	100	400
760138220001000	10x20	38	17,5	black	100	400
760138230001000	10x30	38	17,5	black	300	-
760138240001000	10x40	38	17,5	black	300	300
760138250001000	10x50	38	17,5	black	300	-
760138260001000	10x60	38	17,5	black	250	-
760138270001000	10x70	38	17,5	black	200	400
760138280001000	10x80	38	17,5	black	200	-
760138290001000	10x90	38	17,5	black	50	400
760138300001000	10x100	38	17,5	black	200	-
760138310001000	10x120	38	17,5	black	100	-
760138410001000	12x30	38	19,0	black	250	500
760138420001000	12x40	38	19,0	black	100	400
760138430001000	12x50	38	19,0	black	200	-
760138440001000	12x60	38	19,0	black	100	400
760138450001000	12x70	38	19,0	black	100	400
760138460001000	12x80	38	19,0	black	50	400
760138470001000	12x90	38	19,0	black	100	400
760138480001000	12x100	38	19,0	black	100	400
760148010001000	8x16	48	16,5	black	100	400
760148020001000	8x20	48	16,5	black	250	250

Please note that the product illustrations are exemplary images that could deviate from the ordered/delivered products.

All of the dimensions are in mm should nothing to the contrary be stated.

\*PU = Packaging Unit, SW = Spanner opening, n.w. = not detachable, o. K. = excl. The head, o. B. = excl. The collar, m. R. = with the radius, MOQ = Minimum Order Quantity.

\*\* MOQ: Parts with MOQ, set-up costs may apply.

We exclusively sell to the trade and industry. Please note our minimum order quantities and the minimum order value per delivery.  
We would be pleased to send you an offer that is tailored to your needs should you require special colours, deviating dimensions, bioplastics, or larger order quantities.

## Adjustment screws

Application: height adjustment screws  
Material: polypropylene / steel  
Standard-Colour: black

HVD

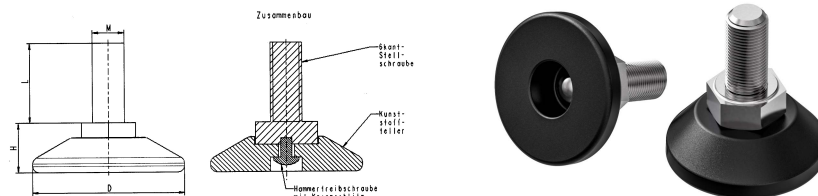

HVD Order No.	Hexagon screw	Plate Ø	Height HVD	Colour	PU*	MOQ**
	M x L	D	H			
760148030001000	8x30	48	16,5	black	250	500
760148040001000	8x40	48	16,5	black	250	-
760148050001000	8x50	48	16,5	black	250	500
760148060001000	8x60	48	16,5	black	200	400
760148070001000	8x70	48	16,5	black	200	400
760148080001000	8x80	48	16,5	black	50	400
760148090001000	8x90	48	16,5	black	100	400
760148100001000	8x100	48	16,5	black	100	400
760148110001000	8x120	48	16,5	black	100	400
760148210001000	10x16	48	17,5	black	100	400
760148220001000	10x20	48	17,5	black	100	400
760148230001000	10x30	48	17,5	black	300	-
760148240001000	10x40	48	17,5	black	250	-
760148250001000	10x50	48	17,5	black	200	-
760148260001000	10x60	48	17,5	black	200	-
760148270001000	10x70	48	17,5	black	200	-
760148280001000	10x80	48	17,5	black	100	-
760148290001000	10x90	48	17,5	black	50	400
760148300001000	10x100	48	17,5	black	100	400
760148310001000	10x120	48	17,5	black	100	400
760148410001000	12x30	48	19,0	black	200	400
760148420001000	12x40	48	19,0	black	200	400
760148430001000	12x50	48	19,0	black	200	400
760148440001000	12x60	48	19,0	black	100	-
760148450001000	12x70	48	19,0	black	150	450
760148460001000	12x80	48	19,0	black	100	400
760148470001000	12x90	48	19,0	black	100	400
760148480001000	12x100	48	19,0	black	100	400
760155210001000	10x16	55	21,0	black	100	400
760155220001000	10x20	55	21,0	black	100	400
760155230001000	10x30	55	21,0	black	200	400

Please note that the product illustrations are exemplary images that could deviate from the ordered/delivered products.

All of the dimensions are in mm should nothing to the contrary be stated.

\*PU = Packaging Unit, SW = Spanner opening, n.w. = not detachable, o. K. = excl. The head, o. B. = excl. The collar, m. R. = with the radius, MOQ = Minimum Order Quantity.

\*\* MOQ: Parts with MOQ, set-up costs may apply.

We exclusively sell to the trade and industry. Please note our minimum order quantities and the minimum order value per delivery.  
We would be pleased to send you an offer that is tailored to your needs should you require special colours, deviating dimensions, bioplastics, or larger order quantities.

## Adjustment screws

Application: height adjustment screws  
Material: polypropylene / steel  
Standard-Colour: black

HVD

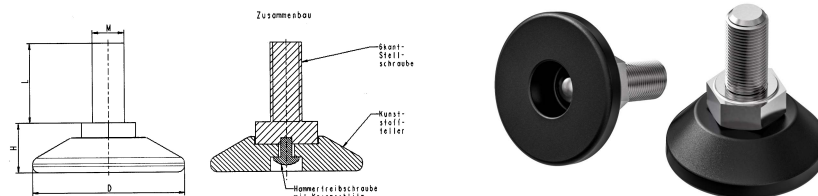

HVD Order No.	Hexagon screw	Plate Ø	Height HVD	Colour	PU*	MOQ**
	M x L	D	H			
760155240001000	10x40	55	21,0	black	100	400
760155250001000	10x50	55	21,0	black	100	400
760155260001000	10x60	55	21,0	black	100	400
760155270001000	10x70	55	21,0	black	100	400
760155280001000	10x80	55	21,0	black	100	400
760155290001000				black	100	400
760155300001000	10x100	55	21,0	black	100	400
760155310001000	10x120	55	21,0	black	100	400
760155410001000	12x30	55	22,5	black	50	400
760155420001000	12x40	55	22,5	black	100	400
760155430001000	12x50	55	22,5	black	100	400
760155440001000	12x60	55	22,5	black	100	-
760155450001000	12x70	55	22,5	black	100	400
760155460001000	12x80	55	22,5	black	100	400
760155470001000	12x90	55	22,5	black	100	400
760155480001000	12x100	55	22,5	black	100	-

Please note that the product illustrations are exemplary images that could deviate from the ordered/delivered products.

All of the dimensions are in mm should nothing to the contrary be stated.

\*PU = Packaging Unit, SW = Spanner opening, n.w. = not detachable, o. K. = excl. The head, o. B. = excl. The collar, m. R. = with the radius, MOQ = Minimum Order Quantity.

\*\* MOQ: Parts with MOQ, set-up costs may apply.

We exclusively sell to the trade and industry. Please note our minimum order quantities and the minimum order value per delivery.  
We would be pleased to send you an offer that is tailored to your needs should you require special colours, deviating dimensions, bioplastics, or larger order quantities.

## Adjustment screws

Application:

Material: polypropylene / steel

Standard-Colour: black

HVF

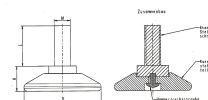

order no.	Hexagon screw	Plate Ø	Height	Colour	PU*	MOQ**
	M x L	D	H			
760238010001000	8x16	38	14,0	black	150	450
760238020001000	8x20	38	14,0	black	100	400
760238030001000	8x30	38	14,0	black	100	-
760238040001000	8x40	38	14,0	black	400	400
760238050001000	8x50	38	14,0	black	100	-
760238060001000	8x60	38	14,0	black	250	-
760238070001000	8x70	38	14,0	black	100	400
760238080001000	8x80	38	14,0	black	200	400
760238090001000	8x90	38	14,0	black	200	400
760238100001000	8x100	38	14,0	black	200	400
760238110001000	8x120	38	14,0	black	50	400
760238210001000	10x16	38	15,0	black	100	400
760238220001000	10x20	38	15,0	black	150	450
760238230001000	10x30	38	15,0	black	400	-
760238240001000	10x40	38	15,0	black	300	-
760238250001000	10x50	38	15,0	black	100	-
760238260001000	10x60	38	15,0	black	200	-
760238270001000	10x70	38	15,0	black	200	400
760238280001000	10x80	38	15,0	black	200	400
760238290001000	10x90	38	15,0	black	50	400
760238300001000	10x100	38	15,0	black	200	-
760238310001000	10x120	38	15,0	black	100	400
760238410001000	12x30	38	16,5	black	250	500
760238420001000	12x40	38	16,5	black	100	400
760238430001000	12x50	38	16,5	black	150	450
760238440001000	12x60	38	16,5	black	100	400
760238450001000	12x70	38	16,5	black	100	400
760238460001000	12x80	38	16,5	black	100	400
760238470001000	12x90	38	16,5	black	100	400
760238480001000	12x100	38	16,5	black	100	400
760248010001000	8x16	48	14,0	black	100	-

Please note that the product illustrations are exemplary images that could deviate from the ordered/delivered products.

All of the dimensions are in mm should nothing to the contrary be stated.

\*PU = Packaging Unit, SW = Spanner opening, n.w. = not detachable, o. K. = excl. The head, o. B. = excl. The collar, m. R. = with the radius, MOQ = Minimum Order Quantity.

\*\* MOQ: Parts with MOQ, set-up costs may apply.

We exclusively sell to the trade and industry. Please note our minimum order quantities and the minimum order value per delivery.  
We would be pleased to send you an offer that is tailored to your needs should you require special colours, deviating dimensions, bioplastics, or larger order quantities.

## Adjustment screws

Application:

Material: polypropylene / steel

Standard-Colour: black

HVF

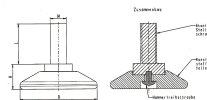

order no.	Hexagon screw	Plate Ø	Height	Colour	PU*	MOQ**
	M x L	D	H			
760248020001000	8x20	48	14,0	black	250	500
760248030001000	8x30	48	14,0	black	250	500
760248040001000	8x40	48	14,0	black	100	400
760248050001000	8x50	48	14,0	black	200	400
760248060001000	8x60	48	14,0	black	200	400
760248070001000	8x70	48	14,0	black	100	400
760248080001000	8x80	48	14,0	black	100	400
760248090001000	8x90	48	14,0	black	100	400
760248100001000	8x100	48	14,0	black	100	400
760248110001000	8x120	48	14,0	black	100	400
760248210001000	10x16	48	15,0	black	300	600
760248220001000	10x20	48	15,0	black	300	600
760248230001000	10x30	48	15,0	black	250	500
760248240001000	10x40	48	15,0	black	200	400
760248250001000	10x50	48	15,0	black	50	-
760248260001000	10x60	48	15,0	black	200	400
760248270001000	10x70	48	15,0	black	200	400
760248280001000	10x80	48	15,0	black	100	400
760248300001000	10x100	48	15,0	black	125	500
760248310001000	10x120	48	15,0	black	125	500
760248410001000	12x30	48	16,5	black	100	400
760248420001000	12x40	48	16,5	black	200	1000
760248430001000	12x50	48	16,5	black	200	1000
760248440001000	12x60	48	16,5	black	50	400
760248450001000	12x70	48	16,5	black	150	450
760248460001000	12x80	48	16,5	black	100	400
760248470001000	12x90	48	16,5	black	100	400
760248480001000	12x100	48	16,5	black	100	400
760255210001000	10x16	55	18,5	black	200	400
760255220001000	10x20	55	18,5	black	300	600
760255230001000	10x30	55	18,5	black	200	400

Please note that the product illustrations are exemplary images that could deviate from the ordered/delivered products.

All of the dimensions are in mm should nothing to the contrary be stated.

\*PU = Packaging Unit, SW = Spanner opening, n.w. = not detachable, o. K. = excl. The head, o. B. = excl. The collar, m. R. = with the radius, MOQ = Minimum Order Quantity.

\*\* MOQ: Parts with MOQ, set-up costs may apply.



We exclusively sell to the trade and industry. Please note our minimum order quantities and the minimum order value per delivery.

We would be pleased to send you an offer that is tailored to your needs should you require special colours, deviating dimensions, bioplastics, or larger order quantities.



## Adjustment screws

Application:

Material: polypropylene / steel

Standard-Colour: black

HVF

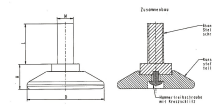

order no.	Hexagon screw	Plate Ø	Height	Colour	PU*	MOQ**
	M x L	D	H			
760255240001000	10x40	55	18,5	black	50	400
760255250001000	10x50	55	18,5	black	100	-
760255260001000	10x60	55	18,5	black	100	400
760255270001000	10x70	55	18,5	black	100	400
760255280001000	10x80	55	18,5	black	100	400
760255290001000	10x90	55	18,5	black	50	400
760255300001000	10x100	55	18,5	black	50	400
760255310001000	10x120	55	18,5	black	100	400
760255410001000	12x30	55	20,0	black	100	400
760255420001000	12x40	55	20,0	black	50	500
760255430001000	12x50	55	20,0	black	100	400
760255440001000	12x60	55	20,0	black	100	400
760255450001000	12x70	55	20,0	black	100	400
760255460001000	12x80	55	20,0	black	100	400
760255470001000	12x90	55	20,0	black	100	400

Please note that the product illustrations are exemplary images that could deviate from the ordered/delivered products.

All of the dimensions are in mm should nothing to the contrary be stated.

\*PU = Packaging Unit, SW = Spanner opening, n.w. = not detachable, o. K. = excl. The head, o. B. = excl. The collar, m. R. = with the radius, MOQ = Minimum Order Quantity.

\*\* MOQ: Parts with MOQ, set-up costs may apply.

We exclusively sell to the trade and industry. Please note our minimum order quantities and the minimum order value per delivery.  
We would be pleased to send you an offer that is tailored to your needs should you require special colours, deviating dimensions, bioplastics, or larger order quantities.

## Adjustment screws

Application: height adjustment screws  
Additional Info: with molded non-slip sole made of EPDM  
Material: PP/TPE Shore A 55° / steel  
Standard-Colour: black

## HVF-HVD 2

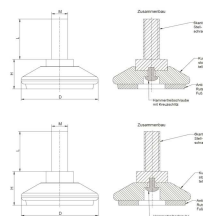

HDV Order No.	Hexagon screw	Plate Ø	Height	Flexibility	Colour	PU*	MOQ**
	M x L	D	H				
762148019905000	8x16	48	19,5	rotating	black	100	400
762148029905000	8x20	48	19,5	rotating	black	100	400
762148039905000	8x30	48	19,5	rotating	black	200	400
762148049905000	8x40	48	19,5	rotating	black	200	-
762148059905000	8x50	48	19,5	rotating	black	100	400
762148069905000	8x60	48	19,5	rotating	black	100	400
762148079905000	8x70	48	19,5	rotating	black	100	400
762148089905000	8x80	48	19,5	rotating	black	100	400
762148099905000	8x90	48	19,5	rotating	black	100	400
762148109905000	8x100	48	19,5	rotating	black	100	400
762148119905000	8x120	48	19,5	rotating	black	100	400
762148219905000	10x16	48	19,5	rotating	black	150	-
762148229905000	10x20	48	19,5	rotating	black	100	500
762148239905000	10x30	48	19,5	rotating	black	250	-
762148249905000	10x40	48	19,5	rotating	black	100	-
762148259905000	10x50	48	19,5	rotating	black	100	-
762148269905000	10x60	48	19,5	rotating	black	200	400
762148279905000	10x70	48	19,5	rotating	black	100	400
762148289905000	10x80	48	19,5	rotating	black	100	400
762148299905000	10x90	48	19,5	rotating	black	100	400
762148309905000	10x100	48	19,5	rotating	black	100	400
762148319905000	10x120	48	19,5	rotating	black	100	400
762248019905000	8x16	48	17,0	fixed	black	250	500
762248029905000	8x20	48	17,0	fixed	black	200	400
762248039905000	8x30	48	17,0	fixed	black	200	400
762248049905000	8x40	48	17,0	fixed	black	200	400
762248059905000	8x50	48	17,0	fixed	black	200	400
762248069905000	8x60	48	17,0	fixed	black	200	400
762248079905000	8x70	48	17,0	fixed	black	200	400
762248089905000	8x80	48	17,0	fixed	black	200	400
762248099905000	8x90	48	17,0	fixed	black	200	400

Please note that the product illustrations are exemplary images that could deviate from the ordered/delivered products.

All of the dimensions are in mm should nothing to the contrary be stated.

\*PU = Packaging Unit, SW = Spanner opening, n.w. = not detachable, o. K. = excl. The head, o. B. = excl. The collar, m. R. = with the radius, MOQ = Minimum Order Quantity.

\*\* MOQ: Parts with MOQ, set-up costs may apply.

! We exclusively sell to the trade and industry. Please note our minimum order quantities and the minimum order value per delivery.  
We would be pleased to send you an offer that is tailored to your needs should you require special colours, deviating dimensions, bioplastics, or larger order quantities.

## Adjustment screws

Application: height adjustment screws  
Material: PP/TPE Shore A 55° / steel  
Standard-Colour: black

## HVF-HVD 2

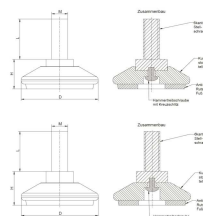

HDV Order No.	Hexagon screw	Plate Ø	Height	Flexibility	Colour	PU*	MOQ**
	M x L	D	H				
762248109905000	8x100	48	17,0	fixed	black	100	400
762248119905000	8x120	48	17,0	fixed	black	200	400
762248219905000	10x16	48	17,0	fixed	black	250	500
762248229905000	10x20	48	17,0	fixed	black	300	-
762248239905000	10x30	48	17,0	fixed	black	200	400
762248249905000	10x40	48	17,0	fixed	black	200	400
762248259905000	10x50	48	17,0	fixed	black	200	-
762248269905000	10x60	48	17,0	fixed	black	200	400
762248279905000	10x70	48	17,0	fixed	black	200	400
762248289905000	10x80	48	17,0	fixed	black	200	400
762248299905000	10x90	48	17,0	fixed	black	200	400
762248309905000	10x100	48	17,0	fixed	black	200	400
762248319905000	10x120	48	17,0	fixed	black	100	400

Please note that the product illustrations are exemplary images that could deviate from the ordered/delivered products.

All of the dimensions are in mm should nothing to the contrary be stated.

\*PU = Packaging Unit, SW = Spanner opening, n.w. = not detachable, o. K. = excl. The head, o. B. = excl. The collar, m. R. = with the radius, MOQ = Minimum Order Quantity.

\*\* MOQ: Parts with MOQ, set-up costs may apply.



We exclusively sell to the trade and industry. Please note our minimum order quantities and the minimum order value per delivery.

We would be pleased to send you an offer that is tailored to your needs should you require special colours, deviating dimensions, bioplastics, or larger order quantities.

## Round adjustment plate with ball joint

HVR

Application: height adjustment screws  
 Material: polyamide / galvanized steel  
 Standard-Colour: black

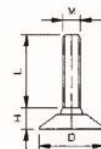
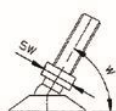
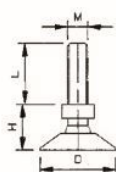

Order No.	Adjuster plate Ø	Thread	Thread length	Height	Hexagon SW	Colour	PU*	MOQ**
	D		L	H	SW			
778126010001000	26	M 8	27,0	11,0	-	black	900	-
778126020001000	26	M 8	33,0	18,5	SW 12	black	100	-
778130010001000	30	M 8	27,0	12,0	-	black	1000	-
778130020001000	30	M 8	33,0	18,5	SW 12	black	100	-
770130020001000	30	M 10	45,0	21,0	SW 12	black	500	-
770130040001000	30	M 10	60,0	21,0	SW 12	black	450	-
770130050001000	30	M 10	70,0	21,0	SW 12	black	400	-
770130060001000	30	M 10	100,0	21,0	SW 12	black	300	-
770140020001000	40	M 10	45,0	21,0	SW 12	black	450	-
770140040001000	40	M 10	60,0	21,0	SW 12	black	400	-
770140050001000	40	M 10	70,0	21,0	SW 12	black	300	-
770140060001000	40	M 10	100,0	21,0	SW 12	black	250	-
770147010001000	47	M 8	27,0	14,0	-	black	600	-
778147010001000	47	M 8	33,0	20,5	SW 12	black	100	-
770147020001000	47	M 10	45,0	21,0	SW 12	black	400	-
770147040001000	47	M 10	60,0	21,0	SW 12	black	350	-
770147050001000	47	M 10	70,0	21,0	SW 12	black	300	-
770147060001000	47	M 10	100,0	21,0	SW 12	black	250	-
770155010001000	55	M 10	25,0	15,0	-	black	450	-
770155020001000	55	M 10	45,0	21,0	SW 12	black	300	-
770155040001000	55	M 10	60,0	21,0	SW 12	black	250	-
770155050001000	55	M 10	70,0	21,0	SW 12	black	250	-
770155060001000	55	M 10	100,0	21,0	SW 12	black	200	200

Please note that the product illustrations are exemplary images that could deviate from the ordered/delivered products.

All of the dimensions are in mm should nothing to the contrary be stated.

\*PU = Packaging Unit, SW = Spanner opening, n.w. = not detachable, o. K. = excl. The head, o. B. = excl. The collar, m. R. = with the radius, MOQ = Minimum Order Quantity.

\*\* MOQ: Parts with MOQ, set-up costs may apply.



We exclusively sell to the trade and industry. Please note our minimum order quantities and the minimum order value per delivery.

We would be pleased to send you an offer that is tailored to your needs should you require special colours, deviating dimensions, bioplastics, or larger order quantities.

## Adjustment screws

Application: height adjustment screws  
Additional Info: with zinc-plated screw, mounted with swivelling plastic plate  
Material: polypropylene  
Standard-Colour: black

HVT

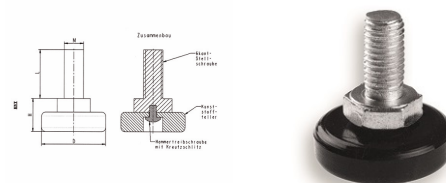

Order No.	Hexagon screw	Plate Ø	Height	Colour	PU*	MOQ**
	M x L	D	H			
760120010001000	8x16	20	15,5	black	200	400
760120020001000	8x20	20	15,5	black	200	-
760120030001000	8x30	20	15,5	black	200	-
760120040001000	8x40	20	15,5	black	200	-
760120050001000	8x50	20	15,5	black	400	-
760120060001000	8x60	20	15,5	black	200	-
760120070001000	8x70	20	15,5	black	200	400
760120080001000	8x80	20	15,5	black	200	400
760120090001000	8x90	20	15,5	black	200	400
760120100001000	8x100	20	15,5	black	100	-
760120110001000	8x120	20	15,5	black	100	400
760120210001000	10x16	20	16,5	black	200	400
760120220001000	10x20	20	16,5	black	400	400
760120230001000	10x30	20	16,5	black	500	-
760120240001000	10x40	20	16,5	black	100	-
760120250001000	10x50	20	16,5	black	300	-
760120260001000	10x60	20	16,5	black	100	400
760120270001000	10x70	20	16,5	black	100	400
760120280001000	10x80	20	16,5	black	100	-
760120290001000	10x90	20	16,5	black	100	400
760120300001000	10x100	20	16,5	black	100	400
760120310001000	10x120	20	16,5	black	100	400
760123010001000	8x16	23	15,5	black	500	500
760123020001000	8x20	23	15,5	black	300	600
760123030001000	8x30	23	15,5	black	200	400
760123040001000	8x40	23	15,5	black	200	400
760123050001000	8x50	23	15,5	black	200	400
760123060001000	8x60	23	15,5	black	100	400
760123070001000	8x70	23	15,5	black	200	400
760123080001000	8x80	23	15,5	black	100	400
760123100001000	8x100	23	15,5	black	100	400

Please note that the product illustrations are exemplary images that could deviate from the ordered/delivered products.

All of the dimensions are in mm should nothing to the contrary be stated.

\*PU = Packaging Unit, SW = Spanner opening, n.w. = not detachable, o. K. = excl. The head, o. B. = excl. The collar, m. R. = with the radius, MOQ = Minimum Order Quantity.

\*\* MOQ: Parts with MOQ, set-up costs may apply.

We exclusively sell to the trade and industry. Please note our minimum order quantities and the minimum order value per delivery.  
We would be pleased to send you an offer that is tailored to your needs should you require special colours, deviating dimensions, bioplastics, or larger order quantities.

## Adjustment screws

Application: height adjustment screws  
Material: polypropylene  
Standard-Colour: black

HVT

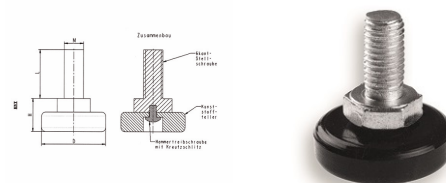

Order No.	Hexagon screw	Plate Ø	Height	Colour	PU*	MOQ**
	M x L	D	H			
760123110001000	8x120	23	15,5	black	100	400
760123210001000	10x16	23	16,5	black	200	400
760123220001000	10x20	23	16,5	black	200	400
760123230001000	10x30	23	16,5	black	200	400
760123240001000	10x40	23	16,5	black	400	-
760123250001000	10x50	23	16,5	black	300	600
760123260001000	10x60	23	16,5	black	100	400
760123270001000	10x70	23	16,5	black	100	-
760123280001000	10x80	23	16,5	black	100	400
760123290001000	10x90	23	16,5	black	100	400
760123300001000	10x100	23	16,5	black	100	400
760123310001000	10x120	23	16,5	black	100	400
760128010001000	8x16	28	15,5	black	200	400
760128020001000	8x20	28	15,5	black	200	400
760128030001000	8x30	28	15,5	black	300	600
760128040001000	8x40	28	15,5	black	200	400
760128050001000	8x50	28	15,5	black	500	500
760128060001000	8x60	28	15,5	black	100	400
760128070001000	8x70	28	15,5	black	100	400
760128080001000	8x80	28	15,5	black	100	400
760128090001000	8x90	28	15,5	black	100	400
760128100001000	8x100	28	15,5	black	100	400
760128110001000	8x120	28	15,5	black	100	400
760128210001000	10x16	28	16,5	black	200	400
760128220001000	10x20	28	16,5	black	200	400
760128230001000	10x30	28	16,5	black	400	-
760128240001000	10x40	28	16,5	black	300	600
760128250001000	10x50	28	16,5	black	300	-
760128260001000	10x60	28	16,5	black	300	-
760128270001000	10x70	28	16,5	black	100	400
760128280001000	10x80	28	16,5	black	100	400

Please note that the product illustrations are exemplary images that could deviate from the ordered/delivered products.

All of the dimensions are in mm should nothing to the contrary be stated.

\*PU = Packaging Unit, SW = Spanner opening, n.w. = not detachable, o. K. = excl. The head, o. B. = excl. The collar, m. R. = with the radius, MOQ = Minimum Order Quantity.

\*\* MOQ: Parts with MOQ, set-up costs may apply.

! We exclusively sell to the trade and industry. Please note our minimum order quantities and the minimum order value per delivery.  
We would be pleased to send you an offer that is tailored to your needs should you require special colours, deviating dimensions, bioplastics, or larger order quantities.

## Adjustment screws

Application: height adjustment screws  
Material: polypropylene  
Standard-Colour: black

HVT

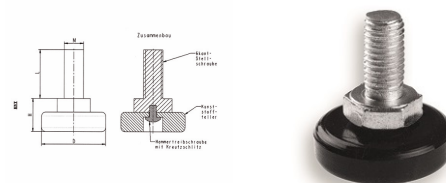

Order No.	Hexagon screw	Plate Ø	Height	Colour	PU*	MOQ**
	M x L	D	H			
760128290001000	10x90	28	16,5	black	100	400
760128300001000	10x100	28	16,5	black	200	-
760128310001000	10x120	28	16,5	black	100	400
760128410001000	12x30	28	17,5	black	100	400
760128420001000	12x40	28	17,5	black	100	400
760128430001000	12x50	28	17,5	black	100	400
760128440001000	12x60	28	17,5	black	100	400
760128450001000	12x70	28	17,5	black	100	400
760128460001000	12x80	28	17,5	black	50	400
760128470001000	12x90	28	17,5	black	100	400
760128480001000	12x100	28	17,5	black	100	400
760133010001000	8x16	33	15,5	black	200	400
760133020001000	8x20	33	15,5	black	200	400
760133030001000	8x30	33	15,5	black	200	400
760133040001000	8x40	33	15,5	black	100	400
760133050001000	8x50	33	15,5	black	500	500
760133060001000	8x60	33	15,5	black	100	400
760133070001000	8x70	33	15,5	black	100	400
760133080001000	8x80	33	15,5	black	100	400
760133090001000	8x90	33	15,5	black	100	400
760133100001000	8x100	33	15,5	black	100	400
760133110001000	8x120	33	15,5	black	100	400
760133210001000	10x16	33	16,5	black	200	400
760133220001000	10x20	33	16,5	black	100	400
760133230001000	10x30	33	16,5	black	400	400
760133240001000	10x40	33	16,5	black	100	400
760133250001000	10x50	33	16,5	black	300	600
760133260001000	10x60	33	16,5	black	100	400
760133270001000	10x70	33	16,5	black	100	400
760133280001000	10x80	33	16,5	black	100	400
760133290001000	10x90	33	16,5	black	100	400

Please note that the product illustrations are exemplary images that could deviate from the ordered/delivered products.

All of the dimensions are in mm should nothing to the contrary be stated.

\*PU = Packaging Unit, SW = Spanner opening, n.w. = not detachable, o. K. = excl. The head, o. B. = excl. The collar, m. R. = with the radius, MOQ = Minimum Order Quantity.

\*\* MOQ: Parts with MOQ, set-up costs may apply.

We exclusively sell to the trade and industry. Please note our minimum order quantities and the minimum order value per delivery.  
We would be pleased to send you an offer that is tailored to your needs should you require special colours, deviating dimensions, bioplastics, or larger order quantities.

## Adjustment screws

Application: height adjustment screws  
Material: polypropylene  
Standard-Colour: black

HVT

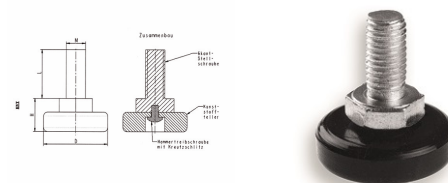

Order No.	Hexagon screw	Plate Ø	Height	Colour	PU*	MOQ**
	M x L	D	H			
760133300001000	10x100	33	16,5	black	100	400
760133310001000	10x120	33	16,5	black	100	400
760133410001000	12x30	33	17,5	black	100	400
760133420001000	12x40	33	17,5	black	100	400
760133430001000				black	100	400
760133440001000	12x60	33	17,5	black	100	400
760133450001000	12x70	33	17,5	black	100	400
760133460001000	12x80	33	17,5	black	100	400
760133470001000	12x90	33	17,5	black	100	400
760133480001000	12x100	33	17,5	black	100	400

Please note that the product illustrations are exemplary images that could deviate from the ordered/delivered products.

All of the dimensions are in mm should nothing to the contrary be stated.

\*PU = Packaging Unit, SW = Spanner opening, n.w. = not detachable, o. K. = excl. The head, o. B. = excl. The collar, m. R. = with the radius, MOQ = Minimum Order Quantity.

\*\* MOQ: Parts with MOQ, set-up costs may apply.

We exclusively sell to the trade and industry. Please note our minimum order quantities and the minimum order value per delivery.  
We would be pleased to send you an offer that is tailored to your needs should you require special colours, deviating dimensions, bioplastics, or larger order quantities.



## Adjustment screws with round plastic base

K 1

Application: adjustment screws  
Material: polyethylene  
Standard-Colour: black

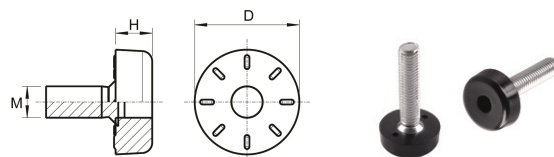

Order No.	Foot Ø	Threaded bolt	Working thread length	Foot height	Colour	PU*	MOQ**
	D	M		H			
076020010001000	20	M 6x15	13,5	7,0	black	1000	-
076020020001000	20	M 6x20	17,5	7,0	black	1000	-
076020040001000	20	M 8x20	18,0	7,0	black	1000	-
076020080001000	20	M 8x30	27,0	7,0	black	500	2000
076020050001000	20	M 10x20	16,0	7,0	black	1000	-
076024010001000	24	M 6x15	13,5	8,0	black	1000	-
076024020001000	24	M 6x20	17,5	8,0	black	750	-
076024030001000	24	M 6x30	27,5	8,0	black	1000	-
076024040001000	24	M 8x20	16,0	8,0	black	1000	-
076024050001000	24	M 8x30	26,0	8,0	black	1000	-
076024060001000	24	M 8x40	36,5	8,0	black	500	-
076024070001000	24	M 8x50	46,5	8,0	black	500	2000
076024080001000	24	M 10x20	17,0	8,0	black	1000	-
076024090001000	24	M 10x30	26,0	8,0	black	500	-
076024100001000	24	M 10x40	36,0	8,0	black	500	-
076024110001000	24	M 10x50	46,0	8,0	black	500	2000

Please note that the product illustrations are exemplary images that could deviate from the ordered/delivered products.

All of the dimensions are in mm should nothing to the contrary be stated.

\*PU = Packaging Unit, SW = Spanner opening, n.w. = not detachable, o. K. = excl. The head, o. B. = excl. The collar, m. R. = with the radius, MOQ = Minimum Order Quantity.

\*\* MOQ: Parts with MOQ, set-up costs may apply.

We exclusively sell to the trade and industry. Please note our minimum order quantities and the minimum order value per delivery.  
We would be pleased to send you an offer that is tailored to your needs should you require special colours, deviating dimensions, bioplastics, or larger order quantities.

## Adjustment screws with round plastic base

K 2

Application: adjustment screws  
Material: polyethylene  
Standard-Colour: black

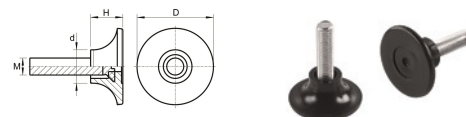

Order No.	Foot Ø	Threaded bolt	Working thread length	Foot height	Shaft Ø	Colour	PU*	MOQ**
	<b>D</b>			<b>H</b>	<b>d</b>			
076045010001000	45	M 10x50	34,5	19,0	19,7	black	250	500

Please note that the product illustrations are exemplary images that could deviate from the ordered/delivered products.

All of the dimensions are in mm should nothing to the contrary be stated.

\*PU = Packaging Unit, SW = Spanner opening, n.w. = not detachable, o. K. = excl. The head, o. B. = excl. The collar, m. R. = with the radius, MOQ = Minimum Order Quantity.

\*\* MOQ: Parts with MOQ, set-up costs may apply.

 We exclusively sell to the trade and industry. Please note our minimum order quantities and the minimum order value per delivery.  
We would be pleased to send you an offer that is tailored to your needs should you require special colours, deviating dimensions, bioplastics, or larger order quantities.

## Adjustment screws with round plastic base

K 3

Application: adjustment screws  
 Material: polyethylene  
 Standard-Colour: black

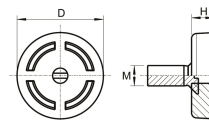

Order No.	Foot Ø	Threaded bolt	Working thread length	Foot height	Colour	PU*	MOQ**
	D	M		H			
076034010001000	34	M 8x20	16,5	9,0	black	500	-
076034020001000	34	M 8x30	25,5	9,0	black	500	-
076034030001000	34	M 8x40	35,5	9,0	black	500	2000
076034040001000	34	M 8x50	46,5	9,0	black	500	2500
076034050001000	34	M 10x20	17,5	9,0	black	500	1500
076034060001000	34	M10x30	25,5	9,0	black	500	2500
076034070001000	34	M 10x40	35,5	9,0	black	500	-
076034080001000	34	M 10x50	46,0	9,0	black	500	-

Please note that the product illustrations are exemplary images that could deviate from the ordered/delivered products.

All of the dimensions are in mm should nothing to the contrary be stated.

\*PU = Packaging Unit, SW = Spanner opening, n.w. = not detachable, o. K. = excl. The head, o. B. = excl. The collar, m. R. = with the radius, MOQ = Minimum Order Quantity.

\*\* MOQ: Parts with MOQ, set-up costs may apply.



We exclusively sell to the trade and industry. Please note our minimum order quantities and the minimum order value per delivery.

We would be pleased to send you an offer that is tailored to your needs should you require special colours, deviating dimensions, bioplastics, or larger order quantities.

## Caps for group HVB

Application: height adjustment screws  
Material: polyethylene  
Standard-Colour: black, uncoloured

KB



Order No.	For HVB	Approx. outside Ø	Height	Colour	PU*	MOQ**
		D	H			
KK300001	30	31,8	4,8	black	5000	-
KK300004	30	31,8	4,8	nature	5000	-
KK450001	45	47,4	6,0	black	2500	-
KK450004	45	47,4	6,0	nature	2500	-
KK600001	60	62,0	6,8	black	1250	-
KK600004	60	62,0	6,8	nature	1250	10000

Please note that the product illustrations are exemplary images that could deviate from the ordered/delivered products.

All of the dimensions are in mm should nothing to the contrary be stated.

\*PU = Packaging Unit, SW = Spanner opening, n.w. = not detachable, o. K. = excl. The head, o. B. = excl. The collar, m. R. = with the radius, MOQ = Minimum Order Quantity.

\*\* MOQ: Parts with MOQ, set-up costs may apply.

 We exclusively sell to the trade and industry. Please note our minimum order quantities and the minimum order value per delivery.  
We would be pleased to send you an offer that is tailored to your needs should you require special colours, deviating dimensions, bioplastics, or larger order quantities.

## Adjustment screws with felt slide base

KF 1

Application: adjustment screws  
Material: polyethylene  
Standard-Colour: black

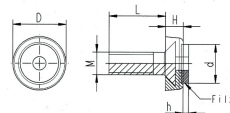

Order No.	Foot Ø	Threaded bolt	Foot height	Working thread length	Felt Ø	Felt height	Colour	PU*	MOQ**
	D		H	L	d	h			
760024020001000	24	M 6x20	8,0	16,0	17,3	3,6	black	750	-
760024040001000	24	M 8x20	8,0	16,0	17,3	3,6	black	1000	-
760024050001000	24	M 8x30	8,0	26,0	17,3	3,6	black	100	-
760024060001000	24	M 8x40	8,0	36,0	17,3	3,6	black	500	1000
760024070001000	24	M 8x50	8,0	46,0	17,3	3,6	black	500	1000
760024080001000	24	M 10x20	8,0	16,0	17,3	3,4	black	1000	1000
760024090001000	24	M 10x30	8,0	26,0	17,3	3,4	black	100	-
760024100001000	24	M 10x40	8,0	36,0	17,3	3,4	black	500	1000
760024110001000	24	M 10x50	8,0	46,0	17,3	3,4	black	500	1000

Please note that the product illustrations are exemplary images that could deviate from the ordered/delivered products.

All of the dimensions are in mm should nothing to the contrary be stated.

\*PU = Packaging Unit, SW = Spanner opening, n.w. = not detachable, o. K. = excl. The head, o. B. = excl. The collar, m. R. = with the radius, MOQ = Minimum Order Quantity.

\*\* MOQ: Parts with MOQ, set-up costs may apply.

We exclusively sell to the trade and industry. Please note our minimum order quantities and the minimum order value per delivery.  
We would be pleased to send you an offer that is tailored to your needs should you require special colours, deviating dimensions, bioplastics, or larger order quantities.

## Adjustment screws with felt slide base

KF 2

Application: adjustment screws  
Material: polyethylene  
Standard-Colour: black

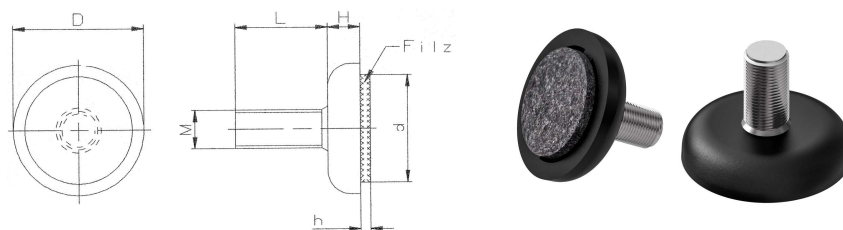

Order No.	Foot Ø	Threaded bolt	Foot height	Working thread length	Felt Ø	Felt height	Colour	PU*	MOQ**
	D		H	L	d	h			
760034010001000	34	M 8x20	8,0	16,0	25	4	black	500	-
760034020001000	34	M 8x30	8,0	26,0	25	4	black	500	-
760034030001000	34	M 8x40	8,0	36,0	27,5	2,3	black	500	2000
760034040001000	34	M 8x50	8,0	46,0	25	4	black	500	2500
760034050001000	34	M 10x20	8,0	16,0	25	4	black	500	1500
760034060001000	34	M 10x30	8,0	24,0	25	4	black	100	-
760034070001000	34	M 10x40	8,0	36,0	25	4	black	500	2500
760034080001000	34	M 10x50	8,0	45,0	25	4	black	500	1500

Please note that the product illustrations are exemplary images that could deviate from the ordered/delivered products.

All of the dimensions are in mm should nothing to the contrary be stated.

\*PU = Packaging Unit, SW = Spanner opening, n.w. = not detachable, o. K. = excl. The head, o. B. = excl. The collar, m. R. = with the radius, MOQ = Minimum Order Quantity.

\*\* MOQ: Parts with MOQ, set-up costs may apply.

! We exclusively sell to the trade and industry. Please note our minimum order quantities and the minimum order value per delivery.  
We would be pleased to send you an offer that is tailored to your needs should you require special colours, deviating dimensions, bioplastics, or larger order quantities.

## Adjustment screws with round plastic base

KK

Application: adjustment screws  
Material: polypropylene  
Standard-Colour: black

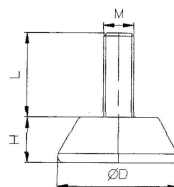

Order No.	Plate Ø	Height	Threaded bolt	Thread length	Colour	PU*	MOQ**
	D	H		L			
077630010001000	30	13	M 6	20	black	500	-
077630020001000	30	13	M 6	30	black	500	-
077630070001000	30	13	M 8	20	black	250	-
077630170001000	30	13	M 10	30	black	250	-
077630190001000	30	13	M 10	50	black	250	-
077630200001000	30	13	M 10	60	black	100	-
077645160001000	45	13	M 10	20	black	100	-
077645170001000	45	13	M 10	30	black	100	-
077645180001000	45	13	M 10	40	black	100	-
077670160001000	70	14	M 10	20	black	50	-
077670200001000	70	14	M 10	60	black	50	250

Please note that the product illustrations are exemplary images that could deviate from the ordered/delivered products.

All of the dimensions are in mm should nothing to the contrary be stated.

\*PU = Packaging Unit, SW = Spanner opening, n.w. = not detachable, o. K. = excl. The head, o. B. = excl. The collar, m. R. = with the radius, MOQ = Minimum Order Quantity.

\*\* MOQ: Parts with MOQ, set-up costs may apply.

We exclusively sell to the trade and industry. Please note our minimum order quantities and the minimum order value per delivery.  
We would be pleased to send you an offer that is tailored to your needs should you require special colours, deviating dimensions, bioplastics, or larger order quantities.

## Adjustment screws with round plastic base

KKO

Application: adjustment screws  
Material: PA/steel  
Standard-Colour: black



Order No.	Plate Ø	Height	Working thread length	Threaded bolt	Colour	PU*	MOQ**
	D	H	L				
077847010001000	47	10,0	13	M 8 x 20	black	250	-
077847020001000	47	10,0	23	M 8 x 30	black	250	-
077847030001000	47	10,0	33	M 8 x 40	black	250	1000
077847040001000	47	10,0	13	M 10 x 20	black	250	1000
077847050001000	47	10,0	23	M 10 x 30	black	250	1000
077847060001000	47	10,0	33	M 10 x 40	black	250	1000
077880020001000	80	15,0	23	M 8 x 30	black	250	1000
077880030001000	80	15,0	33	M 8 x 30	black	250	1000
077880050001000	80	15,0	23	M 10 x 30	black	250	1000
077880060001000	80	15,0	33	M 10 x 40	black	250	1000

Please note that the product illustrations are exemplary images that could deviate from the ordered/delivered products.

All of the dimensions are in mm should nothing to the contrary be stated.

\*PU = Packaging Unit, SW = Spanner opening, n.w. = not detachable, o. K. = excl. The head, o. B. = excl. The collar, m. R. = with the radius, MOQ = Minimum Order Quantity.

\*\* MOQ: Parts with MOQ, set-up costs may apply.

We exclusively sell to the trade and industry. Please note our minimum order quantities and the minimum order value per delivery.  
We would be pleased to send you an offer that is tailored to your needs should you require special colours, deviating dimensions, bioplastics, or larger order quantities.



## Adjustment screws with round plastic base

KL

Application: adjustment screws  
Material: polyamide  
Standard-Colour: black

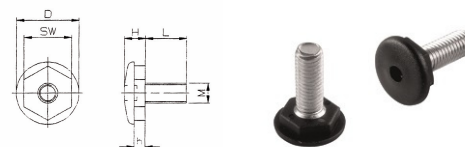

Order No.	Foot Ø	Total height	Working thread length	Thread bolt	Wrench size	Height wrench size	Colour	PU*	MOQ**
	D x SW	H	L		SW	h			
077025010001000	25 SW 19	8,9	17,9	M 8x20	18,9	4,6	black	1000	-
077025020001000	25 SW 19	8,9	25,7	M 8x30	18,9	4,6	black	500	-
077025030001000	25 SW 19	8,9	35,8	M 8x40	18,9	4,6	black	1000	-
077025040001000	25 SW 19	8,9	45,8	M 8x50	18,9	4,6	black	500	2000
077025050001000	25 SW 19	8,7	16,9	M 10x20	19,2	5,0	black	1000	-
077025060001000	25 SW 19	8,7	25,2	M 10x30	19,2	5,0	black	500	2000
077025070001000	25 SW 19	8,7	34,5	M 10x40	19,2	5,0	black	500	2000
077025080001000	25 SW 19	8,7	45,2	M 10x50	19,2	5,0	black	500	2000
077030010001000	30 SW 24	9,0	15,7	M 8x20	24,1	4,5	black	500	2000
077030020001000	30 SW 24	9,0	26,6	M 8x30	24,1	4,5	black	500	-
077030030001000	30 SW 24	9,0	36,6	M 8x40	24,1	4,5	black	500	2000
077030040001000	30 SW 24	9,0	45,2	M 8x50	24,1	4,5	black	500	2000
077030050001000	30 SW 24	9,0	17,0	M 10x20	24,1	4,5	black	500	2000
077030060001000	30 SW 24	9,0	24,8	M 10x30	24,1	4,5	black	500	-
077030070001000	30 SW 24	9,0	34,4	M 10x40	24,1	4,5	black	500	-
077030080001000	30 SW 24	9,0	45,1	M 10x50	24,1	4,5	black	500	2000

Please note that the product illustrations are exemplary images that could deviate from the ordered/delivered products.

All of the dimensions are in mm should nothing to the contrary be stated.

\*PU = Packaging Unit, SW = Spanner opening, n.w. = not detachable, o. K. = excl. The head, o. B. = excl. The collar, m. R. = with the radius, MOQ = Minimum Order Quantity.

\*\* MOQ: Parts with MOQ, set-up costs may apply.

We exclusively sell to the trade and industry. Please note our minimum order quantities and the minimum order value per delivery.  
We would be pleased to send you an offer that is tailored to your needs should you require special colours, deviating dimensions, bioplastics, or larger order quantities.

## Adjustment screws with knurled plastic base

KR

Application: adjustment screws  
Material: polyamide  
Standard-Colour: black

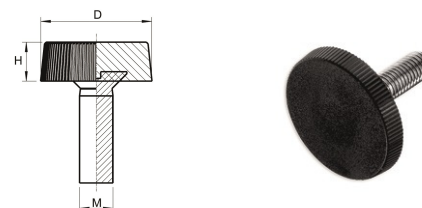

Order No.	Plate Ø	Threaded bolt	Plate height	Working thread length	Colour	PU*	MOQ**
	D	M	H				
076920010001000	20	M 6x20	7,0	17,5	black	1000	-
076920020001000	20	M 6x30	7,0	27,5	black	1000	-
076920030001000	20	M 6x40	7,0	37,5	black	1000	2000
076920040001000	20	M 6x50	7,0	47,5	black	1000	2000
076920060001000	20	M 8x20	7,0	16,5	black	1000	-
076920070001000	20	M 8x30	7,0	26,5	black	1000	-
076920080001000	20	M 8x40	7,0	36,5	black	500	2000
076920090001000	20	M 8x50	7,0	46,5	black	1000	-
076925010001000	25	M 6x20	7,0	17,5	black	1000	-
076925020001000	25	M 6x30	7,0	27,5	black	1000	-
076925030001000	25	M 6x40	7,0	37,5	black	1000	-
076925040001000	25	M 6x50	7,0	47,5	black	500	2000
076925050001000	25	M 8x20	7,0	16,5	black	1000	-
076925060001000	25	M 8x30	7,0	26,5	black	1000	-
076925070001000	25	M 8x40	7,0	36,5	black	500	-
076925080001000	25	M 8x50	7,0	46,5	black	500	-
076925090001000	25	M10x20	7,0	15,5	black	1000	-
076925100001000	25	M 10x30	7,0	25,5	black	1000	-
076925110001000	25	M 10x40	7,0	35,5	black	500	-
076925120001000	25	M 10x50	7,0	45,5	black	500	2000
076930010001000	30	M 6x20	7,0	17,5	black	1000	-
076930020001000	30	M 6x30	7,0	27,5	black	1000	2000
076930030001000	30	M 6x40	7,0	37,5	black	1000	2000
076930040001000	30	M 6x50	7,0	47,5	black	500	2000
076930050001000	30	M 8x20	7,0	16,5	black	1000	-
076930060001000	30	M 8x30	7,0	26,5	black	1000	-
076930070001000	30	M 8x40	7,0	36,5	black	500	-
076930080001000	30	M 8x50	7,0	46,5	black	500	-
076930090001000	30	M 10x20	7,0	15,5	black	1000	-
076930100001000	30	M 10x30	7,0	25,5	black	500	-
076930110001000	30	M 10x40	7,0	35,5	black	500	-

Please note that the product illustrations are exemplary images that could deviate from the ordered/delivered products.

All of the dimensions are in mm should nothing to the contrary be stated.

\*PU = Packaging Unit, SW = Spanner opening, n.w. = not detachable, o. K. = excl. The head, o. B. = excl. The collar, m. R. = with the radius, MOQ = Minimum Order Quantity.

\*\* MOQ: Parts with MOQ, set-up costs may apply.

We exclusively sell to the trade and industry. Please note our minimum order quantities and the minimum order value per delivery.  
We would be pleased to send you an offer that is tailored to your needs should you require special colours, deviating dimensions, bioplastics, or larger order quantities.

## Adjustment screws with knurled plastic base

KR

Application: adjustment screws  
 Material: polyamide  
 Standard-Colour: black

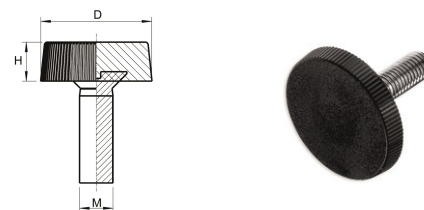

Order No.	Plate Ø	Threaded bolt	Plate height	Working thread length	Colour	PU*	MOQ**
	D	M	H				
076930120001000	30	M 10x50	7,0	45,5	black	500	-
076930130001000	30	M 10x60	7,0	55,5	black	500	-
076935010001000	35	M 6x20	7,0	17,5	black	500	-
076935020001000	35	M 6x30	7,0	27,5	black	500	2000
076935030001000	35	M 6x40	7,0	37,5	black	500	2000
076935040001000	35	M 6x50	7,0	47,5	black	500	2000
076935050001000	35	M 8x20	7,0	16,5	black	500	-
076935060001000	35	M 8x30	7,0	26,5	black	500	-
076935070001000	35	M 8x40	7,0	36,5	black	500	2000
076935080001000	35	M 8x50	7,0	46,5	black	500	2000
076935090001000	35	M 10x20	7,0	15,5	black	500	2000
076935100001000	35	M 10x30	7,0	25,5	black	500	-
076935110001000	35	M 10x40	7,0	35,5	black	500	-
076935120001000	35	M 10x50	7,0	45,5	black	500	-
076935130001000	35	M 10x60	7,0	55,5	black	250	-
076945050001000	45	M 8x20	7,0	16,5	black	500	-
076945060001000	45	M 8x30	7,0	26,5	black	500	-
076945070001000	45	M 8x40	7,0	36,5	black	250	2000
076945080001000	45	M 8x50	7,0	46,5	black	250	2000
076945090001000	45	M 10x20	7,0	15,5	black	500	-
076945100001000	45	M 10x30	7,0	25,5	black	500	-
076945110001000	45	M 10x40	7,0	35,5	black	250	-
076945120001000	45	M 10x50	7,0	45,5	black	250	-
076945130001000	45	M 10x60	7,0	55,5	black	250	2000

Please note that the product illustrations are exemplary images that could deviate from the ordered/delivered products.

All of the dimensions are in mm should nothing to the contrary be stated.

\*PU = Packaging Unit, SW = Spanner opening, n.w. = not detachable, o. K. = excl. The head, o. B. = excl. The collar, m. R. = with the radius, MOQ = Minimum Order Quantity.

\*\* MOQ: Parts with MOQ, set-up costs may apply.

! We exclusively sell to the trade and industry. Please note our minimum order quantities and the minimum order value per delivery.  
 We would be pleased to send you an offer that is tailored to your needs should you require special colours, deviating dimensions, bioplastics, or larger order quantities.

## Adjustment screws with knurled plastic base

Application: adjustment screws  
Material: polyamide  
Standard-Colour: black

KRI

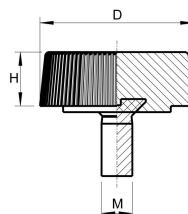

Order No.	Plate Ø	Head height	Threaded bolt	Colour	PU*	MOQ**
	D	H	M			
076919010001000	20	7,0	M 4 x 8/9	black	1000	-
076919020001000	20	7,0	M 4 x 10	black	1000	-
076919030001000	20	7,0	M 4 x 12	black	1000	-
076919040001000	20	7,0	M 4 x 15	black	1000	-
076919050001000	20	7,0	M 4 x 20	black	1000	-
076919060001000	20	7,0	M 4 x 25	black	1000	-
076919070001000	20	7,0	M 5 x 8	black	1000	-
076919080001000	20	7,0	M 5 x 10	black	1000	-
076919090001000	20	7,0	M 5 x 14/15	black	1000	-
076919100001000	20	7,0	M 5 x 17	black	1000	-
076919110001000	20	7,0	M 5 x 19	black	1000	-
076919120001000	20	7,0	M 5 x 24	black	1000	-
076919130001000	20	7,0	M 5 x 29	black	1000	-
076919140001000	20	7,0	M 5 x 34	black	1000	-
076919150001000	20	7,0	M 5 x 39	black	1000	-
076919160001000	20	7,0	M 5 x 49	black	1000	-
076919170001000	20	7,0	M 5 x 58	black	1000	-

Please note that the product illustrations are exemplary images that could deviate from the ordered/delivered products.

All of the dimensions are in mm should nothing to the contrary be stated.

\*PU = Packaging Unit, SW = Spanner opening, n.w. = not detachable, o. K. = excl. The head, o. B. = excl. The collar, m. R. = with the radius, MOQ = Minimum Order Quantity.

\*\* MOQ: Parts with MOQ, set-up costs may apply.

We exclusively sell to the trade and industry. Please note our minimum order quantities and the minimum order value per delivery.  
We would be pleased to send you an offer that is tailored to your needs should you require special colours, deviating dimensions, bioplastics, or larger order quantities.

## Adjustment screws with round plastic base

KS

Application: adjustment screws  
Material: PP/steel  
Standard-Colour: black



Order No.	Plate Ø	Height	Working thread length	Flange Ø	Thread bolt	Colour	PU*	MOQ**
	D	H	L	d	M			
076060010001000	40	10	13	16,5	M 8x20	black	500	-
076060020001000	40	10	23	16,5	M 8x30	black	500	2000
076060030001000	40	10	33	16,5	M 8x40	black	500	2000
076060040001000	40	10	13	16,5	M 10x20	black	500	2000
076060050001000	40	10	23	16,5	M 10x30	black	500	-
076060060001000	40	10	33	16,5	M 10x40	black	500	2000

Please note that the product illustrations are exemplary images that could deviate from the ordered/delivered products.

All of the dimensions are in mm should nothing to the contrary be stated.

\*PU = Packaging Unit, SW = Spanner opening, n.w. = not detachable, o. K. = excl. The head, o. B. = excl. The collar, m. R. = with the radius, MOQ = Minimum Order Quantity.

\*\* MOQ: Parts with MOQ, set-up costs may apply.

We exclusively sell to the trade and industry. Please note our minimum order quantities and the minimum order value per delivery.  
We would be pleased to send you an offer that is tailored to your needs should you require special colours, deviating dimensions, bioplastics, or larger order quantities.

## Adjustment screws with knurled plastic base

KT

Application: adjustment screws  
Material: polyamide  
Standard-Colour: black

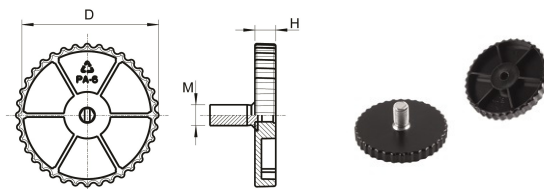

Order No.	Plate Ø	Threaded bolt	Plate height	Working thread length	Colour	PU*	MOQ**
	D	M	H				
076950000001000	50	M 8x20	8,0	17,0	black	500	-
076950020001000	50	M 8x30	8,0	27,0	black	250	1250
076950030001000	50	M 8x40	8,0	37,0	black	500	-
076950040001000	50	M 8x50	8,0	47,0	black	500	1500
076950050001000	50	M 8x60	8,0	57,0	black	500	1000
076950060001000	50	M 10x20	8,0	15,5	black	500	-
076950070001000	50	M 10x30	8,0	25,5	black	500	1000
076950080001000	50	M 10x40	8,0	35,5	black	500	1000
076950090001000	50	M 10x50	8,0	45,5	black	500	1500
076950100001000	50	M 10x60	8,0	55,5	black	500	1000
076955000001000	55	M 8x20	8,0	17,0	black	250	-
076955010001000	55	M 8x25	8,0	22,0	black	500	-
076955020001000	55	M 8x30	8,0	27,0	black	500	-
076955030001000	55	M 8x40	8,0	37,0	black	500	1000
076955040001000	55	M 8x50	8,0	47,0	black	500	1500
076955050001000	55	M 8x60	8,0	57,0	black	250	1250
076955060001000	55	M 10x20	8,0	15,5	black	250	1250
076955070001000	55	M 10x30	8,0	25,5	black	500	1500
076955080001000	55	M 10x40	8,0	35,5	black	500	1500
076955090001000	55	M 10x50	8,0	45,5	black	250	1250
076955100001000	55	M 10x60	8,0	55,5	black	250	1000
076958000001000	58	M 8x20	8,0	17,0	black	250	750
076958010001000	58	M 8x30	8,0	27,0	black	250	1000
076958020001000	58	M 8x40	8,0	37,0	black	250	1250
076958030001000	58	M 8x50	8,0	47,0	black	250	1250
076958040001000	58	M 8x60	8,0	57,0	black	250	1000
076958060001000	58	M 10x20	8,0	15,5	black	250	750
076958070001000	58	M 10x30	8,0	25,5	black	250	1000
076958080001000	58	M 10x40	8,0	35,5	black	250	1000
076958090001000	58	M 10x50	8,0	45,5	black	250	1000
076958100001000	58	M 10x60	8,0	55,5	black	250	1250

Please note that the product illustrations are exemplary images that could deviate from the ordered/delivered products.

All of the dimensions are in mm should nothing to the contrary be stated.

\*PU = Packaging Unit, SW = Spanner opening, n.w. = not detachable, o. K. = excl. The head, o. B. = excl. The collar, m. R. = with the radius, MOQ = Minimum Order Quantity.

\*\* MOQ: Parts with MOQ, set-up costs may apply.

We exclusively sell to the trade and industry. Please note our minimum order quantities and the minimum order value per delivery.  
We would be pleased to send you an offer that is tailored to your needs should you require special colours, deviating dimensions, bioplastics, or larger order quantities.

## Adjustment screws with knurled plastic base

KT

Application: adjustment screws  
Material: polyamide  
Standard-Colour: black

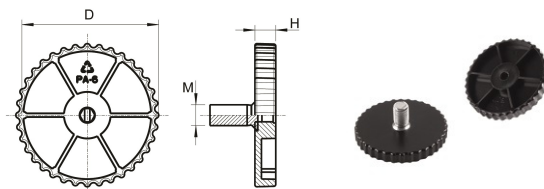

Order No.	Plate Ø	Threaded bolt	Plate height	Working thread length	Colour	PU*	MOQ**
	D	M	H				
076960010001000	60	M 8x20	8,0	17,0	black	500	-
076960020001000	60	M 8x30	8,0	27,0	black	250	-
076960030001000	60	M 8x40	8,0	37,0	black	250	-
076960040001000	60	M 8x50	8,0	47,0	black	250	1000
076960050001000	60	M 8x60	8,0	57,0	black	250	1250
076960060001000	60	M 10x20	8,0	15,5	black	250	-
076960070001000	60	M 10x30	8,0	25,5	black	250	-
076960080001000	60	M 10x40	8,0	35,5	black	250	-
076960090001000	60	M 10x50	8,0	45,5	black	250	-
076960100001000	60	M 10x60	8,0	55,5	black	250	1250
076963000001000	63	M 8x20	8,0	17,0	black	250	-
076963010001000	63	M 8x30	8,0	27,0	black	250	1250
076963020001000	63	M 8x40	8,0	37,0	black	250	1000
076963030001000	63	M 8x50	8,0	47,0	black	250	1250
076963040001000	63	M 8x60	8,0	57,0	black	250	1250
076963060001000	63	M 10x20	8,0	15,5	black	500	-
076963070001000	63	M 10x30	8,0	25,5	black	250	1000
076963080001000	63	M 10x40	8,0	35,5	black	250	1250
076963090001000	63	M 10x50	8,0	45,5	black	250	-
076963100001000	63	M 10x60	8,0	55,5	black	250	1000

Please note that the product illustrations are exemplary images that could deviate from the ordered/delivered products.

All of the dimensions are in mm should nothing to the contrary be stated.

\*PU = Packaging Unit, SW = Spanner opening, n.w. = not detachable, o. K. = excl. The head, o. B. = excl. The collar, m. R. = with the radius, MOQ = Minimum Order Quantity.

\*\* MOQ: Parts with MOQ, set-up costs may apply.

We exclusively sell to the trade and industry. Please note our minimum order quantities and the minimum order value per delivery.  
We would be pleased to send you an offer that is tailored to your needs should you require special colours, deviating dimensions, bioplastics, or larger order quantities.

# anti-slip-foot

Application: anti-slip-foot for the group KT  
Material: TPE  
Standard-Colour: black

KTGC

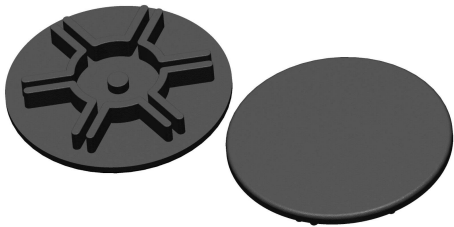
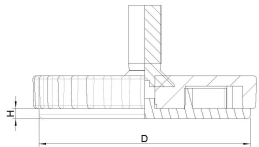

Order No.	For KT	Approx. outside Ø	Height	Colour	PU*	MOQ**
		<b>D</b>	<b>H</b>			
KT500001000	50	47	2,5	black	200	200
KT550001000	55	52	2,5	black	200	200
KT600001000	58,60,63	57	2,5	black	200	200

Please note that the product illustrations are exemplary images that could deviate from the ordered/delivered products.  
All of the dimensions are in mm should nothing to the contrary be stated.  
\*PU = Packaging Unit, SW = Spanner opening, n.w. = not detachable, o. K. = excl. The head, o. B. = excl. The collar, m. R. = with the radius, MOQ = Minimum Order Quantity.  
\*\* MOQ: Parts with MOQ, set-up costs may apply.

 We exclusively sell to the trade and industry. Please note our minimum order quantities and the minimum order value per delivery.  
We would be pleased to send you an offer that is tailored to your needs should you require special colours, deviating dimensions, bioplastics, or larger order quantities.



## Adjustment plate with round plastic base and drill holes

KW

Application: adjustment screws  
Material: PA GF/steel  
Standard-Colour: black

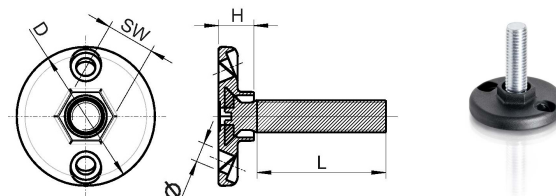

Order No.	Plate Ø	Height	Working thread length	SW	Threaded bolt	Hole Ø	Colour	PU*	MOQ**
	D	H	L						
076070150001000	35	5,0	20	ohne	M 8 x 30	6	black	500	2500
076070160001000	35	5,0	30	ohne	M 8 x 40	6	black	500	2500
076070170001000	35	5,0	40	ohne	M 8 x 50	6	black	500	2500
076070050001000	43	11,0	20	15	M 10 x 30	6	black	400	2000
076070060001000	43	11,0	30	15	M 10 x 40	6	black	400	-
076070070001000	43	11,0	40	15	M 10 x 50	6	black	250	2000

Please note that the product illustrations are exemplary images that could deviate from the ordered/delivered products.

All of the dimensions are in mm should nothing to the contrary be stated.

\*PU = Packaging Unit, SW = Spanner opening, n.w. = not detachable, o. K. = excl. The head, o. B. = excl. The collar, m. R. = with the radius, MOQ = Minimum Order Quantity.

\*\* MOQ: Parts with MOQ, set-up costs may apply.

We exclusively sell to the trade and industry. Please note our minimum order quantities and the minimum order value per delivery.  
We would be pleased to send you an offer that is tailored to your needs should you require special colours, deviating dimensions, bioplastics, or larger order quantities.

## Adjustment screws with hexagonal plastic base

L 1

Application: adjustment screws  
 Material: polyethylene  
 Standard-Colour: black

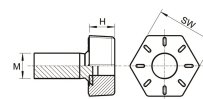

Order No.	Foot dimension <b>SW</b>	Threaded bolt <b>M</b>	Working thread length	Height <b>H</b>	Colour	PU*	MOQ**
079120010001000	20x20	M 8x20	16,0	8,0	black	1000	-
079120020001000	20x20	M 8x30	26,0	8,0	black	1000	-
079120030001000	20x20	M 8x40	36,0	8,0	black	1000	-
079120040001000	20x20	M 8x50	46,0	8,0	black	500	-
079125010001000	25x25	M 8x20	16,0	8,0	black	1000	-
079125020001000	25x25	M 8x30	26,0	8,0	black	1000	-
079125030001000	25x25	M 8x40	36,0	8,0	black	500	-
079125040001000	25x25	M 8x50	46,0	8,0	black	500	-
079125050001000	25x25	M 10x20	15,0	8,0	black	1000	-
079125060001000	25x25	M 10x30	25,0	8,0	black	500	-
079125070001000	25x25	M 10x40	35,0	8,0	black	500	-
079125080001000	25x25	M 10x50	45,0	8,0	black	500	-
079130060001000	30x30	M 8x20	16,0	8,0	black	500	-
079130070001000	30x30	M 8x30	26,0	8,0	black	500	-
079130130001000	30x30	M 8x40	36,0	8,0	black	500	2000
079130120001000	30x30	M 8x50	46,0	8,0	black	500	2000
079130010001000	30x30	M 10x20	15,0	8,0	black	500	-
079130020001000	30x30	M 10x30	25,0	8,0	black	500	-
079130030001000	30x30	M 10x40	35,0	8,0	black	500	-
079130040001000	30x30	M 10x50	45,0	8,0	black	500	-

Please note that the product illustrations are exemplary images that could deviate from the ordered/delivered products.

All of the dimensions are in mm should nothing to the contrary be stated.

\*PU = Packaging Unit, SW = Spanner opening, n.w. = not detachable, o. K. = excl. The head, o. B. = excl. The collar, m. R. = with the radius, MOQ = Minimum Order Quantity.

\*\* MOQ: Parts with MOQ, set-up costs may apply.



We exclusively sell to the trade and industry. Please note our minimum order quantities and the minimum order value per delivery.

We would be pleased to send you an offer that is tailored to your needs should you require special colours, deviating dimensions, bioplastics, or larger order quantities.

## Adjustment screws with square plastic base

L 2

Application: adjustment screws  
Material: polyethylene  
Standard-Colour: black

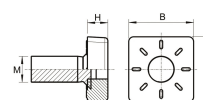

Order No.	Foot dimension	Threaded bolt	Working thread length	Height	Colour	PU*	MOQ**
	D x B	M		H			
079020010001000	20x20	M 8x20	16,0	6,3	black	1000	-
079020020001000	20x20	M 8x30	26,0	6,3	black	1000	2000
079020030001000	20x20	M 8x40	36,0	6,3	black	1000	2000
079020040001000	20x20	M 8x50	46,0	6,3	black	500	2000
079025010001000	25x25	M 8x20	16,0	8,0	black	1000	2000
079025020001000	25x25	M 8x30	26,0	8,0	black	1000	2000
079025030001000	25x25	M 8x40	36,0	8,0	black	500	2000
079025040001000	25x25	M 8x50	46,0	8,0	black	500	2000
079025050001000	25x25	M 10x20	15,0	8,0	black	1000	2000
079025060001000	25x25	M 10x30	25,0	8,0	black	500	2000
079025070001000	25x25	M 10x40	35,0	8,0	black	500	2000
079025080001000	25x25	M 10x50	45,0	8,0	black	500	2000
079030010001000	30x30	M 10x20	15,0	8,0	black	500	2000
079030020001000	30x30	M 10x30	25,0	8,0	black	500	2000
079030030001000	30x30	M 10x40	35,0	8,0	black	500	2000
079030040001000	30x30	M 10x50	45,0	8,0	black	500	2000
079040010001000	40x40	M 8x20	16,0	8,0	black	500	2000
079040020001000	40x40	M 8x30	26,0	8,0	black	500	2000
079040030001000	40x40	M 8x40	36,0	8,0	black	500	2000
079040040001000	40x40	M 8x50	46,0	8,0	black	500	2000
079040050001000	40x40	M 10 x 20	15,0	8,0	black	500	2000
079040060001000	40x40	M 10x30	25,0	8,0	black	500	2000
079040070001000	40x40	M 10x40	35,0	8,0	black	250	2000
079040080001000	40x40	M 10x50	45,0	8,0	black	250	2000

Please note that the product illustrations are exemplary images that could deviate from the ordered/delivered products.

All of the dimensions are in mm should nothing to the contrary be stated.

\*PU = Packaging Unit, SW = Spanner opening, n.w. = not detachable, o. K. = excl. The head, o. B. = excl. The collar, m. R. = with the radius, MOQ = Minimum Order Quantity.

\*\* MOQ: Parts with MOQ, set-up costs may apply.

! We exclusively sell to the trade and industry. Please note our minimum order quantities and the minimum order value per delivery.  
We would be pleased to send you an offer that is tailored to your needs should you require special colours, deviating dimensions, bioplastics, or larger order quantities.

## Adjustment screws, hexagonal, with felt base

LF

Application: adjustment screws  
 Material: polyethylene  
 Standard-Colour: black

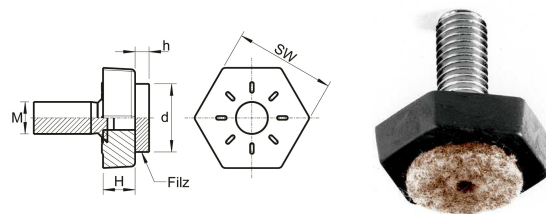

Order No.	Foot dimension	Threaded bolt	Working thread length	Height	Felt dimension	Colour	PU*	MOQ**
	SW	M		H	d x h			
791025010001000	25x25	M 8x20	16,0	8,0	17x3,5	black	500	-
791025020001000	25x25	M 8x30	26,0	8,0	17x3,5	black	100	-
791025030001000	25x25	M 8x40	36,0	8,0	17x3,5	black	500	2000
791025040001000	25x25	M 8x50	46,0	8,0	17x3,5	black	500	2000
791025050001000	25x25	M 10x20	15,0	8,0	17x3,5	black	200	1200
791025060001000	25x25	M 10x30	25,0	8,0	17x3,5	black	500	-
791025070001000	25x25	M 10x40	35,0	8,0	17x3,5	black	500	500
791030060001000	30x30	M 8x20	16,0	8,0	22x3,5	black	500	2000
791030070001000	30x30	M 8x30	26,0	8,0	22x3,5	black	500	2000
791030130001000	30x30	M 8x40	36,0	8,0	22x3,5	black	100	-
791030010001000	30x30	M 10x20	15,0	8,0	22x3,5	black	500	2000
791030020001000	30x30	M 10x30	25,0	8,0	22x3,5	black	500	-
791030030001000	30x30	M 10x40	35,0	8,0	22x3,5	black	500	2000
791030040001000	30x30	M 10x50	45,0	8,0	22x3,5	black	500	1000

Please note that the product illustrations are exemplary images that could deviate from the ordered/delivered products.

All of the dimensions are in mm should nothing to the contrary be stated.

\*PU = Packaging Unit, SW = Spanner opening, n.w. = not detachable, o. K. = excl. The head, o. B. = excl. The collar, m. R. = with the radius, MOQ = Minimum Order Quantity.

\*\* MOQ: Parts with MOQ, set-up costs may apply.



We exclusively sell to the trade and industry. Please note our minimum order quantities and the minimum order value per delivery.

We would be pleased to send you an offer that is tailored to your needs should you require special colours, deviating dimensions, bioplastics, or larger order quantities.

## Adjustment screws with hexagonal plastic base

LS

Application: adjustment screws  
 Material: polyamide  
 Standard-Colour: black

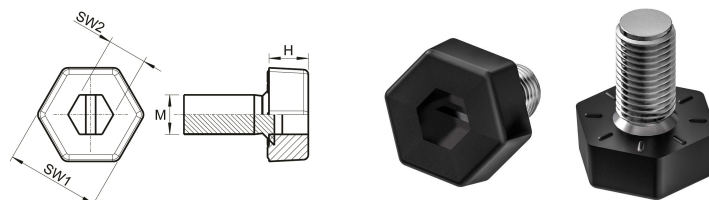

Order No.	Foot dimension	Threaded bolt	Working thread length	Height	Hexagon	Colour	PU*	MOQ**
	SW 1	M		H	SW 2			
792019010001000	SW 19	M 8x20	16,0	8,0	8	black	1000	-
792019020001000	SW 19	M 8x30	26,0	8,0	8	black	1000	-
792019030001000	SW 19	M 8x40	36,0	8,0	8	black	500	-
792019040001000	SW 19	M 8x50	46,0	8,0	8	black	500	-
792027010001000	SW 27	M 8x20	16,0	8,0	8	black	1000	2000
792027020001000	SW 27	M 8x30	26,0	8,0	8	black	500	-
792027030001000	SW 27	M 8x40	36,0	8,0	8	black	500	2000
792027040001000	SW 27	M 8x50	46,0	8,0	8	black	500	2000
792027050001000	SW 27	M 10x20	14,0	8,0	8	black	500	-
792027060001000	SW 27	M 10x30	24,0	8,0	8	black	500	-
792027070001000	SW 27	M 10x40	34,0	8,0	8	black	500	-
792027080001000	SW 27	M 10x50	44,0	8,0	8	black	500	-

Please note that the product illustrations are exemplary images that could deviate from the ordered/delivered products.

All of the dimensions are in mm should nothing to the contrary be stated.

\*PU = Packaging Unit, SW = Spanner opening, n.w. = not detachable, o. K. = excl. The head, o. B. = excl. The collar, m. R. = with the radius, MOQ = Minimum Order Quantity.

\*\* MOQ: Parts with MOQ, set-up costs may apply.

! We exclusively sell to the trade and industry. Please note our minimum order quantities and the minimum order value per delivery.  
 We would be pleased to send you an offer that is tailored to your needs should you require special colours, deviating dimensions, bioplastics, or larger order quantities.

## Adjustment screws, hexagonal

Application: adjustment screws  
Additional Info: hexagonal head, with felt base  
Material: polyamide  
Standard-Colour: black

LSF

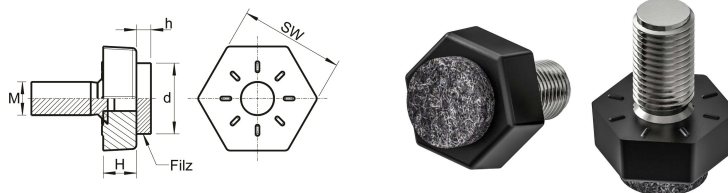

Order No.	Foot dimension	Threaded bolt	Working thread length	Height	Felt dimension	Colour	PU*	MOQ**
	SW	M	L	H	d x h			
791019010001000	SW 19	M 8x20	16,0	8,0	16,0x3,0	black	1000	2000
791019020001000	SW 19	M 8x30	26,0	8,0	16,0x3,0	black	1000	2000
791019030001000	SW 19	M 8x40	36,0	8,0	16,0x3,0	black	1000	2000
791019040001000	SW 19	M 8x50	46,0	8,0	16,0x3,0	black	500	2000
791027010001000	SW 27	M 8x20	16,0	8,0	20,0x3,0	black	1000	2000
791027020001000	SW 27	M 8x30	26,0	8,0	20,0x3,0	black	500	-
791027030001000	SW 27	M 8x40	36,0	8,0	20,0x3,0	black	500	2000
791027040001000	SW 27	M 8x50	46,0	8,0	20,0x3,0	black	1000	2000
791027050001000	SW 27	M 10x20	14,0	8,0	20,0x3,0	black	500	-
791027060001000	SW 27	M 10x30	24,0	8,0	20,0x3,0	black	500	2000
791027070001000	SW 27	M 10x40	34,0	8,0	20,0x3,0	black	500	1500
791027080001000	SW 27	M 10x50	44,0	8,0	20,0x3,0	black	100	1000

Please note that the product illustrations are exemplary images that could deviate from the ordered/delivered products.

All of the dimensions are in mm should nothing to the contrary be stated.

\*PU = Packaging Unit, SW = Spanner opening, n.w. = not detachable, o. K. = excl. The head, o. B. = excl. The collar, m. R. = with the radius, MOQ = Minimum Order Quantity.

\*\* MOQ: Parts with MOQ, set-up costs may apply.

We exclusively sell to the trade and industry. Please note our minimum order quantities and the minimum order value per delivery.  
We would be pleased to send you an offer that is tailored to your needs should you require special colours, deviating dimensions, bioplastics, or larger order quantities.

## Slip stopper for adjusting screws KK 70

Application: adjustment screws  
Material: TPE  
Standard-Colour: uncoloured

YK

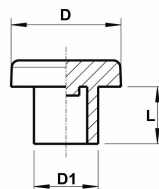

Please note that the product illustrations are exemplary images that could deviate from the ordered/delivered products.

All of the dimensions are in mm should nothing to the contrary be stated.

\*PU = Packaging Unit, SW = Spanner opening, n.w. = not detachable, o. K. = excl. The head, o. B. = excl. The collar, m. R. = with the radius, MOQ = Minimum Order Quantity.

\*\* MOQ: Parts with MOQ, set-up costs may apply.



We exclusively sell to the trade and industry. Please note our minimum order quantities and the minimum order value per delivery.

We would be pleased to send you an offer that is tailored to your needs should you require special colours, deviating dimensions, bioplastics, or larger order quantities.

## Vibration damper with threaded bolt

SDL

Application: machine and device feet  
 Material: NR Shore A 55° / Steel  
 Standard-Colour: black

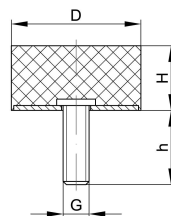

Order No.	Outside Ø	Height	Threaded bolt	Colour	PU*	MOQ**
	D	H				
T294000010001000	10	10	M 4 x 10	black	100	-
T294000020001000	10	15	M 4 x 10	black	100	-
T294000030001000	15	10	M 4 x 10	black	100	-
T294000040001000	15	15	M 4 x 10	black	100	-
T294000050001000	15	20	M 4 x 10	black	100	-
T294000060001000	15	30	M 4 x 10	black	150	150
T294000070001000	20	5	M 6 x 18	black	100	-
T294000080001000	20	10	M 6 x 18	black	100	-
T294000090001000	20	15	M 6 x 18	black	100	-
T294000100001000	20	20	M 6 x 18	black	100	-
T294000110001000	20	25	M 6 x 18	black	100	-
T294000120001000	25	10	M 6 x 18	black	100	-
T294000130001000	25	15	M 6 x 18	black	100	-
T294000140001000	25	17	M 6 x 18	black	100	-
T294000150001000	25	20	M 6 x 18	black	100	-
T294000160001000	25	25	M 6 x 18	black	100	-
T294000170001000	25	30	M 6 x 18	black	100	-
T294000180001000	30	15	M 8 x 20	black	100	-
T294000190001000	30	20	M 8 x 20	black	50	-
T294000200001000	30	25	M 8 x 20	black	50	-
T294000210001000	30	30	M 8 x 20	black	50	-
T294000220001000	40	20	M 8 x 23	black	50	-
T294000230001000	40	25	M 8 x 23	black	50	-
T294000240001000	40	30	M 8 x 23	black	50	-
T294000250001000	40	40	M 8 x 23	black	50	-
T294000260001000	50	20	M 10 x 28	black	50	-
T294000270001000	50	30	M 10 x 28	black	50	-
T294000280001000	50	40	M 10 x 28	black	50	-
T294000290001000	50	45	M 10 x 28	black	50	-
T294000300001000	50	50	M 10 x 28	black	50	-
T294000320001000	75	25	M 12 x 37	black	50	-

Please note that the product illustrations are exemplary images that could deviate from the ordered/delivered products.

All of the dimensions are in mm should nothing to the contrary be stated.

\*PU = Packaging Unit, SW = Spanner opening, n.w. = not detachable, o. K. = excl. The head, o. B. = excl. The collar, m. R. = with the radius, MOQ = Minimum Order Quantity.

\*\* MOQ: Parts with MOQ, set-up costs may apply.

! We exclusively sell to the trade and industry. Please note our minimum order quantities and the minimum order value per delivery.  
 We would be pleased to send you an offer that is tailored to your needs should you require special colours, deviating dimensions, bioplastics, or larger order quantities.



## Vibration damper with threaded bolt

Application: machine and device feet  
Material: NR Shore A 55° / Steel  
Standard-Colour: black

SDL

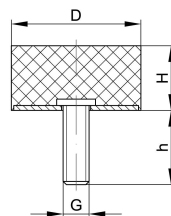

Order No.	Outside Ø	Height	Threaded bolt	Colour	PU*	MOQ**
	<b>D</b>	<b>H</b>				
T294000330001000	75	40	M 12 x 37	black	50	-
T294000340001000	75	50	M 12 x 37	black	50	-

Please note that the product illustrations are exemplary images that could deviate from the ordered/delivered products.

All of the dimensions are in mm should nothing to the contrary be stated.

\*PU = Packaging Unit, SW = Spanner opening, n.w. = not detachable, o. K. = excl. The head, o. B. = excl. The collar, m. R. = with the radius, MOQ = Minimum Order Quantity.

\*\* MOQ: Parts with MOQ, set-up costs may apply.

 We exclusively sell to the trade and industry. Please note our minimum order quantities and the minimum order value per delivery.  
We would be pleased to send you an offer that is tailored to your needs should you require special colours, deviating dimensions, bioplastics, or larger order quantities.

## Collars for square tubes

Application: collars  
Material: acrylonitrile butadiene styrene  
Standard-Colour: black

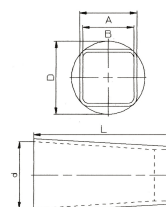

Order No.	Tube dimension	Outside Ø	Outside Ø	Inside Ø	Inside Ø	Length	Colour	PU*	MOQ**
		D	A	B	d	L			
097025250001000	25x25	36,5	28,5	25,5	33,0	70,0	black	250	500
097030300001000	30x30	43,6	33,5	30,5	40,0	70,0	black	100	600

Please note that the product illustrations are exemplary images that could deviate from the ordered/delivered products.

All of the dimensions are in mm should nothing to the contrary be stated.

\*PU = Packaging Unit, SW = Spanner opening, n.w. = not detachable, o. K. = excl. The head, o. B. = excl. The collar, m. R. = with the radius, MOQ = Minimum Order Quantity.

\*\* MOQ: Parts with MOQ, set-up costs may apply.

We exclusively sell to the trade and industry. Please note our minimum order quantities and the minimum order value per delivery.  
We would be pleased to send you an offer that is tailored to your needs should you require special colours, deviating dimensions, bioplastics, or larger order quantities.

## Collars for round tubes

Application: collars  
Material: acrylonitrile butadiene styrene  
Standard-Colour: black

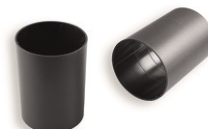
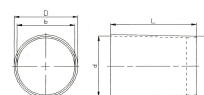

Order No.	Tube outside Ø	Outside Ø	Outside Ø	Inside Ø	Inside Ø	Length	Colour	PU*	MOQ**
		<b>D</b>	<b>A</b>	<b>b</b>	<b>d</b>	<b>L</b>			
097000600001000	60	67,0	63,5	60,5	64,0	90,0	black	100	500

Please note that the product illustrations are exemplary images that could deviate from the ordered/delivered products.

All of the dimensions are in mm should nothing to the contrary be stated.

\*PU = Packaging Unit, SW = Spanner opening, n.w. = not detachable, o. K. = excl. The head, o. B. = excl. The collar, m. R. = with the radius, MOQ = Minimum Order Quantity.

\*\* MOQ: Parts with MOQ, set-up costs may apply.

We exclusively sell to the trade and industry. Please note our minimum order quantities and the minimum order value per delivery.  
We would be pleased to send you an offer that is tailored to your needs should you require special colours, deviating dimensions, bioplastics, or larger order quantities.

## Threaded inserts with metal thread

JR

Application: for round tubes  
Additional Info: Attention! Please consider that not all  
glides have the same clamping ribs form  
Material: polyamide  
Standard-Colour: black

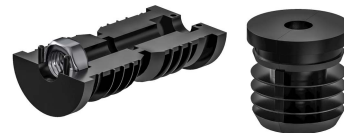
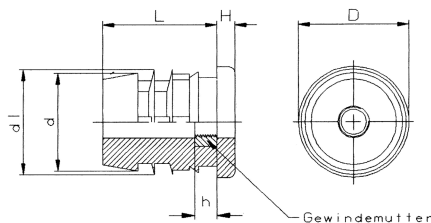

Order No.	Tube outside Ø	Thread nut	Head Ø	Height	Shaft Ø	Ribs Ø	Shaft length	Colour	PU*	MOQ**
			D	H	d	d1	L			
068000160001000	16 x 1,5	M 5	16,1	5,0	13,1	15,0	33,5	black	2000	6000
068000180001000	18 x 1,25	M 5	18,0	2,1	15,7	16,0	33,5	black	1500	6000
068000200001000	20 x 1-1,5	M 8	20,2	5,0	16,0	19,0	33,5	black	1000	-
068200200001000	20 x 2	M 8	20,2	5,0	16,0	17,0	33,5	black	1000	-
068200220001000	22 x 1-2	M 8	22,0	5,0	18,8	21,0	33,5	black	1000	-
068300230001000	23 x 1,5	M 10	23,0	7,5	19,1	20,0	37,0	black	800	3200
068200250001000	25 x 1-2	M 8	25,0	5,0	20,5	24,0	33,5	black	750	-
068300250001000	25 x 1-2	M 10	25,0	5,0	20,5	24,0	33,5	black	750	-
068200280001000	28 x 1-1,5	M 8	28,2	5,0	22,7	26,0	33,5	black	600	-
068300280001000	28 x 1-2	M 10	28,2	5,0	22,7	26,0	33,5	black	600	-
068200300001000	30 x 1,5-2	M 8	30,0	5,0	24,2	28,5	33,5	black	500	-
068300300001000	30 x 1,5-2	M 10	30,0	5,0	24,2	28,5	33,5	black	500	-
068500300001000	30 x 3	M 10	30,0	5,0	22,0	25,0	33,5	black	500	2500
068200320001000	32 x 1-2	M 8	32,0	5,0	27,7	30,5	33,5	black	500	-
068300320001000	32 x 1,5-2	M 10	32,0	5,0	26,8	30,5	33,5	black	500	-
068300340001000	34 x 1-2	M 10	34,0	5,0	27,0	33,0	33,5	black	1500	1500
068200350001000	35 x 1,5-2	M 8	35,0	5,0	30,0	33,5	33,5	black	400	-
068300350001000	35 x 1,5-2	M 10	35,0	5,0	30,0	33,5	33,5	black	400	-
068300380001000	38 x 1,5-2	M 10	38,0	5,0	33,0	34,5	33,5	black	350	-
068300400001000	40 x 1-2	M 10	40,0	5,0	33,5	38,5	33,5	black	300	-
068300420001000	42 x 1-2	M 10	42,0	5,0	34,4	40,0	33,5	black	300	-
068300450001000	45 x 1,5-2	M 10	45,0	5,0	40,0	43,5	33,5	black	250	-
068400450001000	45 x 2	M 10	45,0	5,0	38,8	41,5	33,5	black	200	-
068300500001000	50 x 1,5	M 10	50,0	5,0	43,5	48,0	33,5	black	200	-
068400500001000	50 x 2	M 10	50,0	5,0	43,0	47,0	33,5	black	200	-
068300600001000	60 x 1,5	M 10	60,0	5,0	54,0	57,5	33,5	black	175	525
068300700001000	70 x 3	M 10	70,0	5,0	63,6	65,0	15,0 kurz	black	200	-

Please note that the product illustrations are exemplary images that could deviate from the ordered/delivered products.

All of the dimensions are in mm should nothing to the contrary be stated.

\*PU = Packaging Unit, SW = Spanner opening, n.w. = not detachable, o. K. = excl. The head, o. B. = excl. The collar, m. R. = with the radius, MOQ = Minimum Order Quantity.

\*\* MOQ: Parts with MOQ, set-up costs may apply.

We exclusively sell to the trade and industry. Please note our minimum order quantities and the minimum order value per delivery.  
We would be pleased to send you an offer that is tailored to your needs should you require special colours, deviating dimensions, bioplastics, or larger order quantities.

## Threaded inserts

Application: for round tubes  
Additional Info: Attention! Please consider that not all  
glides have the same clamping ribs form  
Material: polyamide  
Standard-Colour: black

JRK



Order No.	Tube outside Ø	Head Ø	Height	Ribs Ø	Shaft Ø	Shaft length	Thread	Colour	PU*	MOQ**
		D	H	d1	d	L	M			
075100160001000	16	16,1	5,0	15,0	12,0	32,3	8	black	3500	-
075100180001000	18	18,0	5,0	17,0	14,0	32,3	8	black	2500	-
075200180001000	18	18,0	5,0	17,0	14,0	32,3	10	black	2500	-
075100200001000	20	20,0	5,0	19,0	13,0	32,3	8	black	2000	-
075200200001000	20	20,0	5,0	19,0	13,6	32,3	10	black	2000	-
075100220001000	22	22,0	5,0	20,5	19,0	31,5	8	black	2000	-
075200220001000	22	22,0	5,0	20,5	19,0	32,0	10	black	1800	-
075100250001000	25	25,0	5,0	23,5	22,0	32,0	8	black	1500	-
075200250001000	25	25,0	5,0	23,5	22,0	31,6	10	black	1500	-
075100280001000	28	28,0	5,0	26,0	24,0	31,5	8	black	1250	-
075200280001000	28	28,0	5,0	26,0	24,0	31,5	10	black	1250	-
075100300001000	30	30,0	5,0	29,0	27,0	31,0	8	black	1000	-
075200320001000	32	32,0	5,0	29,5	28,0	31,0	10	black	900	-
075300350001000	35	35,0	5,0	33,0	30,0	32,0	22	black	800	-
075300380001000	38	38,0	5,0	34,0	33,0	32,1	22	black	350	-
075300400001000	40	40,0	5,0	38,0	36,0	32,0	22	black	300	-
075300420001000	42	42,0	5,0	40,0	36,0	31,5	22	black	500	-
075300500001000	50	50,0	5,0	48,5	45,0	33,0	22	black	400	-

Please note that the product illustrations are exemplary images that could deviate from the ordered/delivered products.

All of the dimensions are in mm should nothing to the contrary be stated.

\*PU = Packaging Unit, SW = Spanner opening, n.w. = not detachable, o. K. = excl. The head, o. B. = excl. The collar, m. R. = with the radius, MOQ = Minimum Order Quantity.

\*\* MOQ: Parts with MOQ, set-up costs may apply.

We exclusively sell to the trade and industry. Please note our minimum order quantities and the minimum order value per delivery.  
We would be pleased to send you an offer that is tailored to your needs should you require special colours, deviating dimensions, bioplastics, or larger order quantities.

## Threaded inserts with metal thread

JRL

Application: for round tubes  
Additional Info: Attention! Please consider that not all  
glides have the same clamping ribs form  
Material: polyamide  
Standard-Colour: black

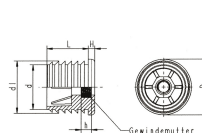

Order No.	Tube outside Ø	Thread	Head Ø D	Height H	Shaft Ø d	Ribs Ø d1	Shaft length L	Colour	PU*	MOQ**
682002200001000	22x1,5-2	M 8	22,0	4,0	17,0	19,5	25,5	black	1000	-
682002500001000	25x1,5-2	M 8	25,0	4,0	18,9	22,5	25,5	black	1000	-
687002500001000	25x3-3,5	M 8	25,0	4,0	17,0	19,5	25,5	black	1000	2000
682002800001000	28x1,5-2	M 8	28,0	4,0	21,0	25,5	25,5	black	1000	-
683002800001000	28x1,5-2	M 10	28,0	4,0	21,0	25,5	25,5	black	1000	-
687002800001000	28x3-3,5	M 8	28,0	4,0	18,9	22,5	25,5	black	1000	2000
682003000001000	30x1,5	M 8	30,0	4,0	23,0	27,5	25,5	black	500	-
683003000001000	30x1,5	M 10	30,0	4,0	23,0	27,5	25,5	black	500	-
686003000001000	30x2-2,5	M 8	30,0	4,0	22,7	26,5	25,5	black	500	-
684003000001000	30x2-2,5	M 10	30,0	4,0	22,7	26,5	25,5	black	500	-
682003200001000	32x1,5	M 8	32,0	4,0	25,0	29,5	25,5	black	500	-
683003200001000	32x1,5	M 10	32,0	4,0	25,0	29,5	25,5	black	500	-
686003200001000	32x2-2,5	M 8	32,0	4,0	25,0	28,5	25,5	black	500	-
684003200001000	32x2-2,5	M 10	32,0	4,0	25,0	28,5	25,5	black	500	-
682003500001000	35x1,5	M 8	35,0	4,0	28,0	32,5	25,5	black	500	-
683003500001000	35x1,5	M 10	35,0	4,0	28,0	32,5	25,5	black	500	-
686003500001000	35x2-2,5	M 8	35,0	4,0	28,0	31,5	25,5	black	500	-
684003500001000	35x2-2,5	M 10	35,0	4,0	28,0	31,5	25,5	black	500	-
682003520001000	35x3,5-4	M 8	35,0	4,0	25,0	28,5	25,5	black	500	2000
683003520001000	35x3,5-4	M 10	35,0	4,0	25,0	28,5	25,5	black	500	1500
681003800001000	38x1,5	M 8	38,0	4,0	30,5	35,8	25,5	black	500	-
683003800001000	38x1,5	M 10	38,0	4,0	30,5	35,8	25,5	black	500	-
682003800001000	38x2-2,5	M 8	38,0	4,0	31,0	34,8	25,5	black	500	1000
684003800001000	38x2-2,5	M 10	38,0	4,0	31,0	34,8	25,5	black	500	-
682004000001000	40x1,5	M 8	40,0	4,0	33,0	37,5	25,5	black	500	-
683004000001000	40x1,5	M 10	40,0	4,0	33,0	37,5	25,5	black	500	-
686004000001000	40x2-2,5	M 8	40,0	4,0	32,0	36,5	25,5	black	500	-
685004000001000	40x2-2,5	M 10	40,0	4,0	32,0	36,5	25,5	black	250	-
687004000001000	40x3-3,5	M 8	40,0	4,0	31,0	34,8	25,5	black	500	1000
688004000001000	40x3-3,5	M 10	40,0	4,0	31,0	34,8	25,5	black	500	1000
682004200001000	42x1,5	M 8	42,0	4,0	35,0	39,5	25,5	black	500	1000

Please note that the product illustrations are exemplary images that could deviate from the ordered/delivered products.

All of the dimensions are in mm should nothing to the contrary be stated.

\*PU = Packaging Unit, SW = Spanner opening, n.w. = not detachable, o. K. = excl. The head, o. B. = excl. The collar, m. R. = with the radius, MOQ = Minimum Order Quantity.

\*\* MOQ: Parts with MOQ, set-up costs may apply.

We exclusively sell to the trade and industry. Please note our minimum order quantities and the minimum order value per delivery.  
We would be pleased to send you an offer that is tailored to your needs should you require special colours, deviating dimensions, bioplastics, or larger order quantities.

## Threaded inserts with metal thread

Application: for round tubes  
Material: polyamide  
Standard-Colour: black

JRL

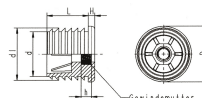

Order No.	Tube outside Ø	Thread	Head Ø	Height	Shaft Ø	Ribs Ø	Shaft length	Colour	PU*	MOQ**
			D	H	d	d1	L			
683004200001000	42x1,5	M 10	42,0	4,0	35,0	39,5	25,5	black	500	1000
686004200001000	42x2-2,5	M 8	42,0	4,0	35,0	38,5	25,5	black	500	1000
684004200001000	42x2-2,5	M 10	42,0	4,0	35,0	38,5	25,5	black	500	1000
687004200001000	42x3-3,5	M 8	42,0	4,0	32,0	36,5	25,5	black	500	1000
688004200001000	42x3-3,5	M 10	42,0	4,0	32,0	36,5	25,5	black	500	1000
682004220001000	42x4-4,5	M 8	42,0	4,0	31,0	34,8	25,5	black	500	1000
682004500001000	45x1,5	M 8	45,0	4,0	38,0	42,5	25,5	black	250	1000
683004500001000	45x1,5	M 10	45,0	4,0	38,0	42,5	25,5	black	250	1000
686004500001000	45x2-2,5	M 8	45,0	4,0	38,0	41,5	25,5	black	250	1000
684004500001000	45x2-2,5	M 10	45,0	4,0	38,0	41,5	25,5	black	250	-
687004500001000	45x3	M 8	45,0	4,0	35,0	39,5	25,5	black	250	1000
688004500001000	45x3	M 10	45,0	4,0	35,0	39,5	25,5	black	250	1000
682005000001000	50x1,5	M 8	50,0	4,0	43,0	47,5	25,5	black	200	-
683005000001000	50x1,5	M 10	50,0	4,0	43,0	47,5	25,5	black	250	-
686005000001000	50x2-2,5	M 8	50,0	4,0	42,0	46,5	25,5	black	250	-
684005000001000	50x2-2,5	M 10	50,0	4,0	42,0	46,5	25,5	black	250	-
682005020001000	50x4	M 8	50,0	4,0	38,0	42,5	25,5	black	250	1000
683005020001000	50x4	M 10	50,0	4,0	38,0	42,5	25,5	black	250	1000
683005400001000	54x1,5	M 10	54,0	4,0	47,0	51,5	25,5	black	250	1000
686005500001000	55x2-2,5	M 8	55,0	4,0	47,0	51,5	25,5	black	200	-
684005500001000	55x2-2,5	M 10	55,0	4,0	47,0	51,5	25,5	black	200	1000
682006000001000	60x1,5	M 8	60,0	4,0	53,0	57,5	25,5	black	250	-
683006000001000	60x1,5	M 10	60,0	4,0	53,0	57,5	25,5	black	200	-
686006000001000	60x2-2,5	M 8	60,0	4,0	53,0	56,5	25,5	black	200	1000
684006000001000	60x2-2,5	M 10	60,0	4,0	53,0	56,5	25,5	black	200	-
682006030001000	60x4,5-5	M 8	60,0	4,0	47,0	51,5	25,5	black	200	1000
686007000001000	70x3	M 8	70,0	4,0	61,0	64,5	25,5	black	250	1000
685007000001000	70x3	M 10	70,0	4,0	61,0	64,5	25,5	black	250	1000

Please note that the product illustrations are exemplary images that could deviate from the ordered/delivered products.

All of the dimensions are in mm should nothing to the contrary be stated.

\*PU = Packaging Unit, SW = Spanner opening, n.w. = not detachable, o. K. = excl. The head, o. B. = excl. The collar, m. R. = with the radius, MOQ = Minimum Order Quantity.

\*\* MOQ: Parts with MOQ, set-up costs may apply.

We exclusively sell to the trade and industry. Please note our minimum order quantities and the minimum order value per delivery.  
We would be pleased to send you an offer that is tailored to your needs should you require special colours, deviating dimensions, bioplastics, or larger order quantities.

## Threaded inserts for rectangular tubes

J 2

Application: for rectangular tubes  
Material: polyethylene  
Standard-Colour: black

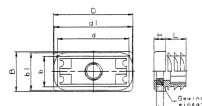

Order No.	Tube dimension	Thread	Head	Height	Shaft	Ribs	Shaft length	Colour	PU*	MOQ**
		M	D x B	H	d x b	d1 x b1	L			
068350250001000	50x25	M 10	50,0x25,1	8,0	45,4x19,4	49,5x23,5	13,0	black	500	-
068350300001000	50x30	M 10	50,2x30,1	5,0	46,0x28,2	46,7x27,0	30,9	black	300	-
068350400001000	50x40	M 10	50,0x40,1	6,5	44,5x34,5	47,9x37,9	17,0	black	500	1000
068360300001000	60x30	M 10	60,2x30,2	6,0	53,7x24,7	57,8x28,0	13,5	black	500	-

Please note that the product illustrations are exemplary images that could deviate from the ordered/delivered products.

All of the dimensions are in mm should nothing to the contrary be stated.

\*PU = Packaging Unit, SW = Spanner opening, n.w. = not detachable, o. K. = excl. The head, o. B. = excl. The collar, m. R. = with the radius, MOQ = Minimum Order Quantity.

\*\* MOQ: Parts with MOQ, set-up costs may apply.

We exclusively sell to the trade and industry. Please note our minimum order quantities and the minimum order value per delivery.  
We would be pleased to send you an offer that is tailored to your needs should you require special colours, deviating dimensions, bioplastics, or larger order quantities.



## Threaded inserts with for square tubes

J 3

Application: for square tubes  
Material: polyethylene  
Standard-Colour: black

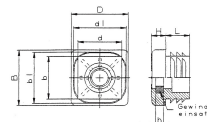

Order No.	Tube dimension	Thread	Head	Height	Shaft Ø	Ribs	Shaft length	Colour	PU*	MOQ**
		M	D x B	H	d x b	d1 x b1	L			
068220200001000	20x20	M 8	20,5x20,5	6,0	14,7x14,7	19,0x19,0	14,2	black	1000	-
068225250001000	25x25	M 8	25,8x25,8	7,0	19,1x19,1	22,5x22,5	13,6	black	1000	-
068325250001000	25x25	M 10	26,0x26,0	6,5	18,5x18,5	23,3x23,3	12,8	black	1000	-
068230300001000	30x30	M 8	29,8x29,8	8,0	23,0x23,0	27,0x27,0	12,8	black	500	-
068330300001000	30x30	M 10	29,8x29,8	8,0	24,0x24,0	28,3x28,3	12,8	black	1000	-
068430300001000	30x30x2,5	M 10	29,8x29,8	8,0	23,0x23,0	26,8x26,8	13,0	black	500	-
068630300001000	30x30 R6	M 10	29,8x29,8	8,0	24,0x24,0	28,8x28,8	12,8	black	1000	-
068335350001000	35x35	M 10	34,8x34,8	8,0	29,3x29,3	33,8x33,8	13,2	black	500	-
068340400001000	40x40	M 10	39,6x39,6	8,0	33,7x33,7	38,2x38,2	13,2	black	500	-
068345450001000	45x45	M 10	44,7x44,7	8,0	39,2x39,2	42,5x42,5	13,4	black	500	-

Please note that the product illustrations are exemplary images that could deviate from the ordered/delivered products.

All of the dimensions are in mm should nothing to the contrary be stated.

\*PU = Packaging Unit, SW = Spanner opening, n.w. = not detachable, o. K. = excl. The head, o. B. = excl. The collar, m. R. = with the radius, MOQ = Minimum Order Quantity.

\*\* MOQ: Parts with MOQ, set-up costs may apply.

We exclusively sell to the trade and industry. Please note our minimum order quantities and the minimum order value per delivery.  
We would be pleased to send you an offer that is tailored to your needs should you require special colours, deviating dimensions, bioplastics, or larger order quantities.

## Screwed corner connection

JEH

Application: for rectangular tubes  
Additional Info: for edgewise positioned tubes, 2 sections. Attention! Please consider that not all glides have the same clamping ribs fo

Material: polyamide  
Standard-Colour: black

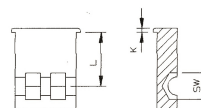

Order No.	Tube dimension	SW chamber for steel nut	Spacing	Plate thickness	Colour	PU*	MOQ**
			<b>L</b>	<b>K</b>			
685302020001000	30x20x1,5	M 8	15,0	2,0	black	600	-
686302020001000	30x20x1,5	2x M 8	15,0	2,0	black	250	-
685402020001000	40x20x1,5	M 8	30,0	2,0	black	250	-
686402020001000	40x20x1,5	2x M 8	30,0	2,0	black	250	-
687403020001000	40x30x1,5	M 10	30,0	2,0	black	250	-
688403020001000	40x30x1,5	2x M 10	30,0	2,0	black	250	-
687452530001000	45x25x2	M 10	20,0	3,0	black	300	-
688452530001000	45x25x2	2x M 10	20,0	3,0	black	250	-
687502530001000	50x25x2	M 10	20,0	3,0	black	250	-
688502530001000	50x25x2	2x M 10	20,0	3,0	black	250	-
687503020001000	50x30x1,5	M 10	30,0	2,0	black	300	-
688503020001000	50x30x1,5	2x M 10	30,0	3,0	black	250	-

Please note that the product illustrations are exemplary images that could deviate from the ordered/delivered products.

All of the dimensions are in mm should nothing to the contrary be stated.

\*PU = Packaging Unit, SW = Spanner opening, n.w. = not detachable, o. K. = excl. The head, o. B. = excl. The collar, m. R. = with the radius, MOQ = Minimum Order Quantity.

\*\* MOQ: Parts with MOQ, set-up costs may apply.

We exclusively sell to the trade and industry. Please note our minimum order quantities and the minimum order value per delivery.  
We would be pleased to send you an offer that is tailored to your needs should you require special colours, deviating dimensions, bioplastics, or larger order quantities.

## Screwcorner connection for square tubes, 2 sections

Application: screwed/screwed corner connection  
Material: polyamide  
Standard-Colour: black

JEV

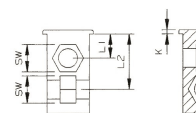

Order No.	Tube dimension	For tube wall thickness	WS chamber for steel nut	Spacing	Spacing	Head height	Colour	PU*	MOQ**
				L1	L2	K			
680202020001000	20x20	1,5	M 8	10,0		2,0	black	1000	-
680202030001000	20x20	2,0	M 8	10,0		2,0	black	250	-
680252520001000	25x25	1,5	M 8	12,5		2,0	black	600	-
681252520001000	25x25	1,5	M 10	12,5		2,0	black	250	-
681303010001000	30x30	1,3	M 10	15,0		2,0	black	400	400
680303020001000	30x30	1,5	M 8	15,0		2,0	black	400	-
680303030001000	30x30	2,0	M 8	15,0		2,0	black	400	-
681303030001000	30x30	2,0	M 10	15,0		2,0	black	400	-
682202020001000	20x20	1,5	M 8	-	27,0	2,0	black	250	-
682202030001000	20x20	2,0	M 8	-	27,0	2,0	black	250	-
682252520001000	25x25	1,5	M 8	-	30,0	2,0	black	250	-
683252520001000	25x25	1,5	M 10	-	30,0	2,0	black	250	-
682303020001000	30x30	1,5	M 8	-	32,0	2,0	black	250	-
682303030001000	30x30	2,0	M 8	-	33,0	2,0	black	250	-
683303030001000	30x30	2,0	M 10	-	33,0	2,0	black	250	-

Please note that the product illustrations are exemplary images that could deviate from the ordered/delivered products.

All of the dimensions are in mm should nothing to the contrary be stated.

\*PU = Packaging Unit, SW = Spanner opening, n.w. = not detachable, o. K. = excl. The head, o. B. = excl. The collar, m. R. = with the radius, MOQ = Minimum Order Quantity.

\*\* MOQ: Parts with MOQ, set-up costs may apply.

We exclusively sell to the trade and industry. Please note our minimum order quantities and the minimum order value per delivery.  
We would be pleased to send you an offer that is tailored to your needs should you require special colours, deviating dimensions, bioplastics, or larger order quantities.

## Zinc diecast inserts for square/rectangular tubes

JM

Application: for square and rectangular tubes  
 Material: zinc diecast  
 Standard-Colour: metal

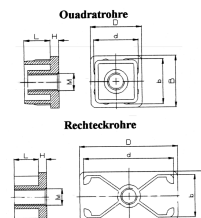

Order No.	Tube dimension	Height	Shaft dimension	Length	Thread	Colour	PU*	MOQ**
	B	H	d x b	L	M			
078125250004000	25x25x1,5	5,0	22,3x22,3	15,0	M 10	nature	100	100
078225250004000	25x25x2	5,0	21,3x21,3	15,0	M 10	nature	400	400
078130300004000	30x30x1,5	5,0	27,4x27,4	15,0	M 10	nature	200	200
078230300004000	30x30x2	5,0	26,2x26,2	15,0	M 10	nature	400	400
078430300004000	30x30x2,5	5,0	25,2x25,2	15,0	M 10	nature	150	150
078240400004000	40x40x2	5,0	36,2x36,2	15,0	M 10	nature	100	100
078250250004000	50x25x2	5,0	46,2x21,2	15,0	M 10	nature	100	100
078250300004000	50x30x2	5,0	46,2x26,3	15,0	M 10	nature	100	100
078260300004000	60x30x2	5,0	56,1x26,4	15,0	M 10	nature	200	200
078480300004000	80x30x2,5	5,0	75,0x25,3	15,0	M 10	nature	75	75

Please note that the product illustrations are exemplary images that could deviate from the ordered/delivered products.

All of the dimensions are in mm should nothing to the contrary be stated.

\*PU = Packaging Unit, SW = Spanner opening, n.w. = not detachable, o. K. = excl. The head, o. B. = excl. The collar, m. R. = with the radius, MOQ = Minimum Order Quantity.

\*\* MOQ: Parts with MOQ, set-up costs may apply.



We exclusively sell to the trade and industry. Please note our minimum order quantities and the minimum order value per delivery.

We would be pleased to send you an offer that is tailored to your needs should you require special colours, deviating dimensions, bioplastics, or larger order quantities.

## Heavy duty inserts with metal thread

JS

Application: for square tubes  
Additional Info: Attention! Please consider that not all glides have the same clamping ribs form  
Material: PA GF / steel  
Standard-Colour: black

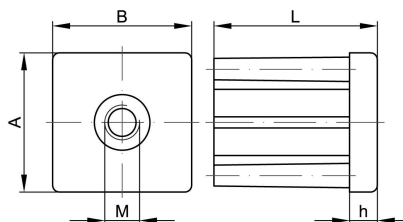

Order No.	Tube dimension	Thread	Flange height	Shaft dimension	Length	Axial load capacity	Colour	PU*	MOQ**
	A x B	M	h		L	N			
M170340001000	30 x 30 x 1,5	M 10	6,0	27,5 x 27,5	33,0	5500	black	140	140
M170350001000	30 x 30 x 1,5	M 12	6,0	27,5 x 27,5	33,0	5500	black	100	100
M170430001000	40 x 40 x 1,5	M 10	8,0	37,5 x 37,5	43,0	8000	black	100	100
M170440001000	40 x 40 x 1,5	M 12	8,0	37,5 x 37,5	43,0	8000	black	130	100
M170460001000	40 x 40 x 1,5	M 16	8,0	37,5 x 37,5	43,0	8000	black	130	100
M170480001000	40 x 40 x 2,0	M 10	8,0	36,5 x 36,5	43,0	8000	black	100	100
M170490001000	40 x 40 x 2,0	M 12	8,0	36,5 x 36,5	43,0	8000	black	100	100
M170510001000	40 x 40 x 2,0	M 16	8,0	36,5 x 36,5	43,0	8000	black	130	100
M170520001000	40 x 40 x 2,0	M 20	8,0	36,5 x 36,5	43,0	8000	black	100	100
M170530001000	50 x 50 x 1,5	M 12	10,0	47,5 x 47,5	55,0	9500	black	120	100
M170550001000	50 x 50 x 1,5	M 16	10,0	47,5 x 47,5	55,0	9500	black	130	100
M170590001000	50 x 50 x 2,5	M 16	10,0	45,5 x 45,5	55,0	9500	black	130	100
M170600001000	50 x 50 x 2,5	M 20	10,0	45,5 x 45,5	55,0	9500	black	130	100

Please note that the product illustrations are exemplary images that could deviate from the ordered/delivered products.

All of the dimensions are in mm should nothing to the contrary be stated.

\*PU = Packaging Unit, SW = Spanner opening, n.w. = not detachable, o. K. = excl. The head, o. B. = excl. The collar, m. R. = with the radius, MOQ = Minimum Order Quantity.

\*\* MOQ: Parts with MOQ, set-up costs may apply.

We exclusively sell to the trade and industry. Please note our minimum order quantities and the minimum order value per delivery.  
We would be pleased to send you an offer that is tailored to your needs should you require special colours, deviating dimensions, bioplastics, or larger order quantities.

## Inserts with metal thread for square tubes

JV 1

Application: for square tubes  
Material: polyamide  
Standard-Colour: black

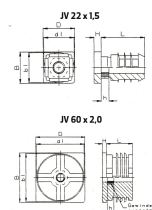

Order No.	Tube dimension	Thread	Head	Height	Ribs	Shaft length	Colour	PU*	MOQ**
		M	D x B	H	d1 x b1	L			
068222220001000	22x22x1,5	M 8	22,0x22,0	5,0	21,0x21,0	33,5	black	1000	3500
068360600001000	60x60x2,0	M 10	60,0x60,0	5,0	Ø 59,3	33,5	black	144	-
068560600001000	60x60x2,0	M 12	60,0x60,0	5,0	Ø 59,4	33,5	black	144	-

Please note that the product illustrations are exemplary images that could deviate from the ordered/delivered products.

All of the dimensions are in mm should nothing to the contrary be stated.

\*PU = Packaging Unit, SW = Spanner opening, n.w. = not detachable, o. K. = excl. The head, o. B. = excl. The collar, m. R. = with the radius, MOQ = Minimum Order Quantity.

\*\* MOQ: Parts with MOQ, set-up costs may apply.

! We exclusively sell to the trade and industry. Please note our minimum order quantities and the minimum order value per delivery.  
We would be pleased to send you an offer that is tailored to your needs should you require special colours, deviating dimensions, bioplastics, or larger order quantities.

## Inserts with metal thread for rectangular tubes

Application: for rectangular tubes  
Material: polyamide  
Standard-Colour: black

JV 2

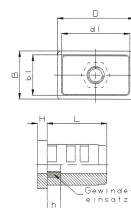

Order No.	Tube dimension	Thread	Head	Height	Ribs	Shaft length	Colour	PU*	MOQ**
		<b>M</b>	<b>D x B</b>	<b>H</b>	<b>d1 x b1</b>	<b>L</b>			
068225200001000	25x20x1-2	M 8	25,2x20,2	5,0	22,0x18,7	33,5	black	500	-
068240250001000	40x25x2	M 8	40,0x25,0	5,0	35,7x22,0	33,5	black	450	-
068345250001000	45x25x1-2	M 10	45,0x24,0	5,0	42,5x22,0	22,5	black	500	1500
068260250001000	60x25x2	M 8	60,0x25,2	5,0	56,3x21,3	33,5	black	300	-
068360250001000	60x25x2	M 10	60,0x25,2	5,0	56,3x21,3	33,5	black	300	-
068370300001000	70x30x2	M 10	70,0x30,1	5,0	67,4x28,0	33,5	black	200	-
068380300001000	80x30x1-2	M 10	80,0x30,0	5,0	76,8x39,3	33,5	black	150	-

Please note that the product illustrations are exemplary images that could deviate from the ordered/delivered products.

All of the dimensions are in mm should nothing to the contrary be stated.

\*PU = Packaging Unit, SW = Spanner opening, n.w. = not detachable, o. K. = excl. The head, o. B. = excl. The collar, m. R. = with the radius, MOQ = Minimum Order Quantity.

\*\* MOQ: Parts with MOQ, set-up costs may apply.

We exclusively sell to the trade and industry. Please note our minimum order quantities and the minimum order value per delivery.  
We would be pleased to send you an offer that is tailored to your needs should you require special colours, deviating dimensions, bioplastics, or larger order quantities.

## Threaded inserts for triangle tubes

J 1

Application: for triangular tubes  
Material: polyethylene  
Standard-Colour: black

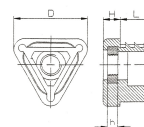

Order No.	Tube dimension	Thread insert	Head dimension	Height	For wall thickness	Shaft length	Colour	PU*	MOQ**
		<b>M</b>	<b>D</b>	<b>H</b>		<b>L</b>			
068835350001000	35x35x35	M 10	je 34,5	7,5	1,5-2,0	14,6	black	500	1000

Please note that the product illustrations are exemplary images that could deviate from the ordered/delivered products.

All of the dimensions are in mm should nothing to the contrary be stated.

\*PU = Packaging Unit, SW = Spanner opening, n.w. = not detachable, o. K. = excl. The head, o. B. = excl. The collar, m. R. = with the radius, MOQ = Minimum Order Quantity.

\*\* MOQ: Parts with MOQ, set-up costs may apply.

 We exclusively sell to the trade and industry. Please note our minimum order quantities and the minimum order value per delivery.  
We would be pleased to send you an offer that is tailored to your needs should you require special colours, deviating dimensions, bioplastics, or larger order quantities.



## Roller holder for square/rectangular tubes

Application: roller holder  
Additional Info: Attention! Please consider that not all glides have the same clamping ribs form  
Material: polyethylene  
Standard-Colour: black

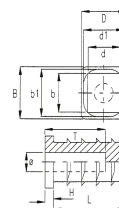

Order No.	Tube dimension	Drilled hole Ø	Head	Height	Shaft length	Insertion depth	Colour	PU*	MOQ**
			D x B	H	L	T			
055020200001000	20x20	8	20,0x20,0	4,0	34,0	35,00	black	1000	1000
055120200001000	20x20	10	20,0x20,0	4,0	34,0	35,00	black	1000	1000
055025250001000	25x25	8	25,0x25,0	4,0	34,0	35,00	black	1000	1000
055125250001000	25x25	10	25,0x25,0	4,0	34,0	35,00	black	1000	1000
055030300001000	30x30	8	30,0x30,0	4,0	34,0	35,00	black	500	500
055130300001000	30x30	10	30,0x30,0	4,0	34,0	35,00	black	500	500

Please note that the product illustrations are exemplary images that could deviate from the ordered/delivered products.

All of the dimensions are in mm should nothing to the contrary be stated.

\*PU = Packaging Unit, SW = Spanner opening, n.w. = not detachable, o. K. = excl. The head, o. B. = excl. The collar, m. R. = with the radius, MOQ = Minimum Order Quantity.

\*\* MOQ: Parts with MOQ, set-up costs may apply.

We exclusively sell to the trade and industry. Please note our minimum order quantities and the minimum order value per delivery.  
We would be pleased to send you an offer that is tailored to your needs should you require special colours, deviating dimensions, bioplastics, or larger order quantities.

## Inserts for roller holders

Application: roller holder  
Material: PA  
Standard-Colour: black

CE

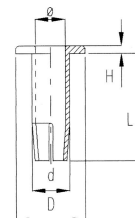

Order No.	Article	Head Ø	Height	Length	Hole Ø	Shaft Ø	Colour	PU*	MOQ**
		<b>D</b>	<b>H</b>	<b>L</b>		<b>d</b>			
056000080001000	für Stift Ø 8 mm	18,1	2,1	28,4	8,0	10,0	black	5000	5000

Please note that the product illustrations are exemplary images that could deviate from the ordered/delivered products.

All of the dimensions are in mm should nothing to the contrary be stated.

\*PU = Packaging Unit, SW = Spanner opening, n.w. = not detachable, o. K. = excl. The head, o. B. = excl. The collar, m. R. = with the radius, MOQ = Minimum Order Quantity.

\*\* MOQ: Parts with MOQ, set-up costs may apply.

 We exclusively sell to the trade and industry. Please note our minimum order quantities and the minimum order value per delivery.  
We would be pleased to send you an offer that is tailored to your needs should you require special colours, deviating dimensions, bioplastics, or larger order quantities.

## Roller holder

CG 1

Application: roller holder  
Additional Info: with tube coupling for square and rectangular tubes  
Material: polyethylene  
Standard-Colour: black

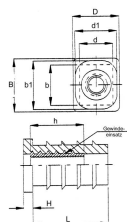

Order No.	Tube dimension	Threaded coupling	Head	Ribs	Shaft	Height	Shaft length	Insertion	Colour	PU*	MOQ**
			D x B	d1 x b1	d x b	H	L	h			
057320200001000	20x20	M 8	20,2x20,2	19,0x19,0	15,0x15,0	6,8	30,5	25,0	black	500	-
057325250001000	25x25	M 8	25,7x25,7	23,0x23,0	19,0x19,0	6,8	29,4	15,0	black	1000	-
057425250001000	25x25	M 10	25,0x25,0	23,0x23,0	19,0x19,0	6,8	29,4	15,0	black	1000	-
057330300001000	30x30	M 8	30,0x30,0	28,0x28,0	24,0x24,0	7,6	30,0	15,0	black	500	-
057430300001000	30x30	M 10	30,0x30,0	28,0x28,0	24,0x24,0	7,6	30,0	15,0	black	500	-
057630300001000	30x30 R6	M 10	30,0x30,0	28,0x28,0	24,0x24,0	7,6	30,0	15,0	black	500	-

Please note that the product illustrations are exemplary images that could deviate from the ordered/delivered products.

All of the dimensions are in mm should nothing to the contrary be stated.

\*PU = Packaging Unit, SW = Spanner opening, n.w. = not detachable, o. K. = excl. The head, o. B. = excl. The collar, m. R. = with the radius, MOQ = Minimum Order Quantity.

\*\* MOQ: Parts with MOQ, set-up costs may apply.

We exclusively sell to the trade and industry. Please note our minimum order quantities and the minimum order value per delivery.  
We would be pleased to send you an offer that is tailored to your needs should you require special colours, deviating dimensions, bioplastics, or larger order quantities.

## Roller holder

Application: roller holder  
Additional Info: with nut for square and rectangular tubes  
Material: polyethylene  
Standard-Colour: black

CG 2

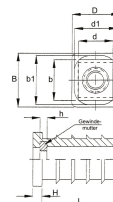

Order No.	Tube dimension	Thread nut	Head	Ribs	Shaft	Height	Shaft length	Insertion	Colour	PU*	MOQ**
			D x B	d1 x b1	d x b	H	L	h			
057120200001000	20x20	M 8	20,2x20,2	19,0x19,0	15,0x15,0	6,2	30,5	4,5	black	1000	-
057125250001000	25x25	M 8	25,7x25,7	23,0x23,0	19,0x19,0	6,8	29,4	4,5	black	500	-
057225250001000	25x25	M 10	25,0x25,0	23,0x23,0	19,0x19,0	6,8	29,4	5,0	black	500	-
057230300001000	30x30	M 10	30,0x30,0	28,0x28,0	24,0x24,0	7,7	30,0	5,0	black	500	-

Please note that the product illustrations are exemplary images that could deviate from the ordered/delivered products.

All of the dimensions are in mm should nothing to the contrary be stated.

\*PU = Packaging Unit, SW = Spanner opening, n.w. = not detachable, o. K. = excl. The head, o. B. = excl. The collar, m. R. = with the radius, MOQ = Minimum Order Quantity.

\*\* MOQ: Parts with MOQ, set-up costs may apply.

We exclusively sell to the trade and industry. Please note our minimum order quantities and the minimum order value per delivery.  
We would be pleased to send you an offer that is tailored to your needs should you require special colours, deviating dimensions, bioplastics, or larger order quantities.